



**California Department of Fish and Wildlife
Central Region
1234 EAST SHAW AVENUE
FRESNO, CALIFORNIA 93710**

California Endangered Species Act
Incidental Take Permit No. 2081-2024-024-04

WEST HILLS WATER TREATMENT PLANT EXPANSION

I. Authority:

This California Endangered Species Act (CESA) incidental take permit (ITP) is issued by the California Department of Fish and Wildlife (CDFW) pursuant to Fish and Game Code section 2081, subdivisions (b) and (c), and California Code of Regulations, Title 14, section 783.0 et seq. CESA prohibits the take¹ of any species of wildlife designated by the California Fish and Game Commission as an endangered, threatened, or candidate species.² However, CDFW may authorize the take of any such species by permit pursuant to the conditions set forth in Fish and Game Code section 2081, subdivisions (b) and (c). (See Cal. Code Regs., tit. 14, § 783.4.)

Permittee:	San Benito County Water District
Principal Officer:	Dana Jacobson, General Manager
Contact Person:	Dana Jacobson, (831) 637-8218
Mailing Address:	30 Mansfield Road Hollister, California 95023

II. Effective Date and Expiration Date of this ITP:

This ITP is effective as of the date signed by CDFW below. Unless renewed by CDFW, this ITP and its authorization to take the Covered Species shall expire on **December 31, 2027**.

Notwithstanding the expiration date on the take authorization provided by this ITP, Permittee's obligations pursuant to this ITP do not end until CDFW accepts as complete the Permittee's Final Mitigation Report required by Condition of Approval Final Mitigation Report of this ITP.

¹Pursuant to Fish and Game Code section 86, "'take' means hunt, pursue, catch, capture, or kill, or attempt to hunt, pursue, catch, capture, or kill." (See also *Environmental Protection Information Center v. California Department of Forestry and Fire Protection* (2008) 44 Cal.4th 459, 507 [for purposes of incidental take permitting under Fish and Game Code section 2081, subdivision (b), "'take' ... means to catch, capture or kill".])

²The definition of an endangered, threatened, and candidate species for purposes of CESA are found in Fish and Game Code sections 2062, 2067, and 2068, respectively.

III. Project Location:

The West Hills Water Treatment Plant Expansion (Project) is located at the West Hills Water Treatment Plant (WHWTP) in an unincorporated area of San Benito County, approximately one mile west of the City of Hollister in the hills north of Union Road (Figure 1). The Project is located at approximately 36.841108, -121.433137 (WHWTP site), and at approximately 36.834291, -121.438953 (raw water pump station). The Project site is surrounded by grassland and rural residences.

IV. Project Description:

The San Benito County Water District plans to expand the existing WHWTP from a capacity of 4.5 million gallons per day (MGD) to a capacity of 6.75 MGD by adding several new facilities within the WHWTP site and raw water pump station. The Project includes a drying bed, an automatic strainer, a pretreatment basin, a filter basin, a chemical storage tank, a raw water pump, piping improvements, and asphalt repairs (Figures 2-4). The majority of the proposed facilities will be constructed within existing paved, graveled, and/or graded areas devoid of vegetation within the existing approximately 5.11-acre WHWTP developed footprint (WHWTP site and raw water pump station). The existing approximately 5.11-acre WHWTP was completed in July 2017 and was permitted under CESA ITP No. 2081-2014-075-04 for the planned buildout of the WHWTP to a developed footprint of 5.3 acres to support a future capacity of 9.0 MGD.

Drying Bed and Staging Area

The new drying bed will be added north of the two existing drying beds at the WHWTP site for a total of three drying beds (Figure 2). The new drying bed will have a surface area of approximately 10,000 square feet and a depth of 4 feet. Installation of the new drying bed will include excavation and grading of the site; installation of underdrain piping; placement of gravel and sand media layers; construction of soil cement walls and concrete decant box; and integration with existing systems. The equipment needed to complete the drying bed installation will include excavators, concrete mixers, and compaction equipment.

The staging area will be located west of the new drying bed within a space reserved for a fourth drying bed, which may be installed in the future. The staging area and the new drying bed will be located on existing graded pads and will expand slightly into the annual grassland along the perimeter of the existing graded pads and drying beds. The existing graded pads are currently used to spread and load solids from the drying beds. Installation of the new drying bed and use of the staging area will result in the development of approximately 0.07 acres of grassland and the temporary disturbance of approximately 0.42 acres of grassland at the WHTWP site (Figure 5).

Auto-strainer

The new automatic strainer (auto-strainer) will be installed adjacent to the existing auto-strainers, which are located south of the drying beds at the WHWTP site (Figure 2). Installation of the auto-strainer will include excavation and foundation preparation; installation of the auto-strainer system; integration with existing pipelines; electrical and control system connections; and performance testing and calibration. The equipment needed to install the

Incidental Take Permit
No. 2081-2024-024-04
SAN BENITO COUNTY WATER DISTRICT
WEST HILLS WATER TREATMENT PLANT EXPANSION

auto-strainer includes backhoes, welding equipment, and electrical tools. All work associated with the installation of the auto-strainer will be conducted within existing paved or graveled areas at the WHWTP site.

Pretreatment Basin

The new pretreatment basin will be added west of the existing pretreatment basin within the paved WHWTP site (Figure 2). Installation of the pretreatment basin will include concrete basin construction (formwork and pouring of basin); installation of equipment (chemical dosing piping and injectors); integration with chemical dosing systems; and testing and commissioning. The equipment needed to install the pretreatment basin will include concrete pumps and rebar bending tools. All work associated with the installation of the pretreatment basin will be conducted within existing paved or graveled areas at the WHWTP site.

Filter Basin

The new filter basin will be added south of the existing filter basins within the paved WHWTP site (Figure 2). Installation of the filter basin will include basin construction and structural reinforcement; installation of filter media and underdrain piping; and testing and commissioning. Equipment needed to install the filter basin will include cranes and concrete finishing tools. All work associated with the installation of the filter basin will be conducted within existing paved or graveled areas at the WHWTP site.

Chemical Storage Tank

The chemical storage tank will be installed south of the existing chemical storage tanks (Figure 2). Installation of the chemical storage tank will include secondary containment construction; placement and anchoring of storage tank; installation of chemical feed lines and safety systems; piping and pump system integration; and leak testing and commissioning. Equipment needed to install the storage tank will include cranes, forklifts, and welding tools. All work associated with the installation of the chemical storage tank will be conducted within existing paved or graveled areas at the WHWTP site.

Raw Water Pump

The new raw water pump will be built adjacent to the existing pumps at the raw water pump station located on the north side of Union Road at the intersection with Richardson Road (Figure 3). The raw water pump station is located within an existing fenced yard with gravel substrate. No expansion of the pump station footprint is required, and no new offsite water pipelines or other components will be required. Installation of the raw water pump will include excavation and foundation work; concrete placement; pump installation; piping integration; electrical work; and testing and commissioning. Equipment needed to install the raw water pump will include excavators and trenching tools for foundation work; concrete mixers and pumps for foundation construction; cranes and hoists for pump placement; and welding and pipefitting tools for installation. All work associated with the installation of the raw water pump will be conducted within existing paved or graveled areas at the raw water pump station.

Piping Improvements

Piping improvements will consist of demolition, excavation, trenching, backfilling, and paving. Trenches will typically be 1 foot wide and 3 feet deep. Excavated material will be stockpiled along the trenches and all demolished asphalt will be hauled offsite. Existing pipelines will be removed, and new pipelines will be installed, pressure tested and flushed. Once pipeline installation is completed, all trenches will be backfilled with native material and surfaces will be repaved. All piping improvements will occur within previously disturbed areas within the existing WHWTP site (Figure 4).

Construction Schedule

Project construction is estimated to occur between the summer of 2025 and summer of 2026. Construction work would primarily occur during weekdays (Monday through Friday) between the hours of 8:00 am and 4:30 pm. No night work is anticipated.

V. Covered Species Subject to Take Authorization Provided by this ITP:

This ITP covers the following species:

<u>Name</u>	<u>CESA Status</u> ³
1. California tiger salamander (<i>Ambystoma californiense</i>)	Threatened ⁴

This species and only this species is the “Covered Species” for the purposes of this ITP.

VI. Impacts of the Taking on Covered Species:

Project activities and their resulting impacts are expected to result in the incidental take of individuals of the Covered Species. The activities described above expected to result in incidental take of individuals of the Covered Species include Project-related vehicle traffic; clearing and removing vegetation; demolition; excavating; grading; compacting; concrete pouring; equipment installation; trenching; stockpiling soils and materials; pipeline installation; backfilling; paving; operating heavy equipment; staging and laying down equipment; and other related activities described in the Project Description of this ITP (Covered Activities).

Incidental take of individuals of the Covered Species in the form of mortality (“kill”) may occur as a result of Covered Activities such as striking or crushing of individuals of the Covered Species during operation of vehicles and heavy equipment, stockpiling of soils and materials, and staging and laying down equipment; entrapment and desiccation of the Covered Species within trenches, holes, open pipes, and uncovered excavations; and burrow collapse and entombment of individuals of the Covered Species in occupied burrows during vegetation removal and clearance, excavation, grading, compacting, concrete pouring, and heavy equipment operation and staging, resulting in crushing or suffocating. Incidental take of individuals of the Covered Species may also occur from the Covered Activities in the form of pursue, catch, capture, or attempt to do so of the Covered Species from uncovering and collecting through the excavation of burrow systems; corralling into confined areas when

³Under CESA, a species may be on the list of endangered species, the list of threatened species, or the list of candidate species.

⁴See Cal. Code Regs. tit. 14 § 670.5, subd. (b)(3)(G).

barrier fencing is installed; and when individuals of the Covered Species are salvaged, collected, and relocated or translocated out of harm's way as required by this ITP. The areas where authorized take of the Covered Species is expected to occur include: the approximately 5.11-acre WHWTP developed footprint, the 0.49 acres of annual grassland along the perimeter of the existing drying beds and graded pads, and the existing paved road between the raw water pump station and the WHWTP site (collectively, the Project Area).

The Project is expected to cause the permanent loss of upland habitat for the Covered Species consisting of **0.07 acres** of annual grassland habitat, and temporary loss of upland habitat for the Covered Species consisting of **0.42 acres** of annual grassland habitat (Figure 5). The annual grassland habitat is located around the perimeter of the existing drying beds and the adjacent graded pads which are used to spread and load solids from the drying beds for off haul. On March 24, 2025, ground squirrel burrow complexes were found within the disturbance area that individuals of the Covered Species could use for underground refugia, shelter, foraging, and protection. The Project is not expected to impact Covered Species aquatic breeding habitat. Aquatic features identified adjacent to, but outside of the Project Area include a relict seasonal wetland feature approximately 22 meters away from the existing WHWTP site, which may provide suitable breeding habitat for the Covered Species.

Impacts of the authorized taking also include adverse impacts to the Covered Species related to reduced conditions for Covered Species movement/dispersal, physiological and/or behavioral disruptions, temporal habitat losses, edge effects, and the Project's incremental contribution to cumulative impacts (indirect impacts). These impacts include altering the conditions of and disruptions to Covered Species dispersal as a result of temporary loss of approximately **5.11 acres** of potential dispersal habitat consisting of hardscape and areas devoid of vegetation (paved, graveled, and/or graded areas at the WHWTP site and raw water pump station). Impacts to this potential dispersal habitat could result in restricted Covered Species movement and could subject individuals of the Covered Species to disperse via longer movement routes resulting in decreased reproductive output, increased energetic expense, and associated increased risk of vehicle strikes, predation, or desiccation. Although Covered Species may disperse over these features, the lack of refugia and cover within the 5.11 acres increases the risk of predation and desiccation for any Covered Species individual present in that area. The primary cause of potential direct take is likely to be from capture when Covered Species are collected and relocated out of harm's way as required by this ITP. In addition, indirect impacts include stress, disorientation, and disruptions to Covered Species resulting from noise, ground vibrations, and fugitive dust; exclusion from or avoidance of preferred foraging and sheltering habitat; and increased vulnerability to predation.

VII. Incidental Take Authorization of Covered Species:

This ITP authorizes incidental take of the Covered Species and only the Covered Species. With respect to incidental take of the Covered Species, CDFW authorizes the Permittee, its employees, contractors, and agents to take Covered Species incidentally in carrying out the Covered Activities, subject to the limitations described in this section and the Conditions of Approval identified below. This ITP does not authorize take of Covered Species from

Incidental Take Permit
No. 2081-2024-024-04
SAN BENITO COUNTY WATER DISTRICT
WEST HILLS WATER TREATMENT PLANT EXPANSION

activities outside the scope of the Covered Activities, take of Covered Species outside of the Project Area, take of Covered Species resulting from violation of this ITP, or intentional take of Covered Species except for capture and relocation of Covered Species as authorized by this ITP.

VIII. Conditions of Approval:

Unless specified otherwise, the following measures apply to all Covered Activities within the Project Area, including areas used for vehicular ingress and egress, staging and parking, and noise and vibration generating activities that may/will cause take. CDFW's issuance of this ITP and Permittee's authorization to take the Covered Species are subject to Permittee's compliance with and implementation of the following Conditions of Approval:

- 1. Legal Compliance:** Permittee shall comply with all applicable federal, State, and local laws in existence on the effective date of this ITP or adopted thereafter.
- 2. CEQA Compliance:** Permittee shall implement and adhere to the mitigation measures related to the Covered Species in the Biological Resources section of the Environmental Impact Report (SCH No.: 2012081028) certified by San Benito County Water District on April 30, 2014, as lead agency for the Project pursuant to the California Environmental Quality Act (CEQA) (Pub. Resources Code, § 21000 et seq.), and the Addendum to the Environmental Impact Report approved by San Benito County Water District on April 16, 2025.
- 3. ESA Compliance:** Permittee shall implement and adhere to the terms and conditions related to the Covered Species in the Biological Opinion for the West Hills Water Treatment Plant, San Benito County, California (official Biological Opinion No. 2014-F-0297) for the Project pursuant to the Federal Endangered Species Act (ESA). For purposes of this ITP, where the terms and conditions for the Covered Species in the federal authorization are less protective of the Covered Species or otherwise conflict with this ITP, the conditions of approval set forth in this ITP shall control.
- 4. ITP Time Frame Compliance:** Permittee shall fully implement and adhere to the conditions of this ITP within the time frames set forth below and as set forth in the Mitigation Monitoring and Reporting Program (MMRP), which is included as Attachment 1 to this ITP.
- 5. General Provisions:**
 - 5.1. Designated Representative.** Before starting Covered Activities, Permittee shall designate a representative (Designated Representative) responsible for communications with CDFW and overseeing compliance with this ITP. Permittee shall notify CDFW (see Notices section below for contact information) in writing before starting Covered Activities of the Designated Representative's name, business address, and contact information, and shall notify CDFW in writing if a

Incidental Take Permit
No. 2081-2024-024-04
SAN BENITO COUNTY WATER DISTRICT
WEST HILLS WATER TREATMENT PLANT EXPANSION

substitute Designated Representative is selected or identified at any time during the term of this ITP.

- 5.2. Designated Biologist(s)/Designated Monitor(s).** Before starting Covered Activities, Permittee shall submit to CDFW in writing the name, qualifications, business address, and contact information of the proposed Designated Biologist(s) using the Biologist Resume Form (Attachment 2) or another format containing the same information. Permittee shall review the qualifications of the proposed Designated Biologist(s) before submission to CDFW and ensure that the proposed Designated Biologist(s) is/are knowledgeable and experienced in the Covered Species' biology and natural history, collecting and handling of the Covered Species, excavating burrows and crevices to minimize mortality of Covered Species, and monitoring construction activities following the Conditions of Approval of an ITP for the Covered Species. Permittee shall obtain CDFW approval of the proposed Designated Biologist(s) in writing before starting Covered Activities. CDFW may approve Designated Monitors who do not meet the qualifications of a Designated Biologist, to assist the Designated Biologist(s) with compliance monitoring and/or implementation of specific Conditions of Approval. The responsibilities of the Designated Monitor(s) shall be restricted to specific Conditions of Approval, as specified by the Permittee or Designated Representative at the time their qualifications are submitted for review, and as approved by CDFW. Permittee shall submit to CDFW in writing the name, qualifications, business address, and contact information of the proposed Designated Monitor(s) using the Biologist Resume Form (Attachment 2) or another format containing the same information. Permittee shall obtain CDFW approval of the proposed Designated Monitor(s) in advance and in writing by CDFW, and shall also obtain approval in advance, in writing, if the Designated Biologist(s) or Designated Monitor(s) must be changed. The Designated Biologist(s) and Designated Monitor(s) shall be responsible for monitoring Covered Activities to help minimize or avoid the incidental take of individual Covered Species and to minimize disturbance of Covered Species' habitat.
- 5.3. Designated Biologist and Designated Monitor Authority.** To ensure compliance with the Conditions of Approval of this ITP, the Designated Biologist(s) and Designated Monitor(s) shall immediately stop any activity that does not comply with this ITP and/or order any reasonable measure to avoid the unauthorized take of an individual of the Covered Species. Permittee shall provide unfettered access to the Project Area and otherwise facilitate the Designated Biologist(s) and Designated Monitor(s) in the performance of their duties. If the Designated Biologist(s) and/or Designated Monitor(s) are unable to comply with the ITP, then the Designated Biologist(s) and/or Designated Monitor(s) shall notify the CDFW Regional Representative (detailed in the Notices section below) immediately. Permittee shall not enter into any agreement or contract of any kind, including but not limited to non-disclosure agreements and confidentiality agreements, with its contractors and/or the Designated Biologist(s)/Designated Monitor(s) that prohibit or impede

open communication with CDFW, including but not limited to providing CDFW staff with the results of any surveys, reports, or studies or notifying CDFW of any non-compliance or take. Failure to notify CDFW of any non-compliance or take or injury of a Covered Species as a result of such agreement or contract may result in CDFW taking actions to prevent or remedy a violation of this ITP.

- 5.4. Education Program.** Permittee shall conduct an education program for all persons employed or otherwise working in the Project Area before they can perform any work within the Project Area. Permittee shall provide the same instruction to any new workers before they are authorized to perform work in the Project Area. Permittee shall repeat this training at least once annually for long-term and/or permanent employees that will be conducting work in the Project Area. The program shall consist of a presentation from the Designated Biologist(s) that includes: (1) a discussion of the biology, life history, and general behavior of the Covered Species; (2) information about the distribution and habitat needs of the Covered Species; (3) sensitivity of the Covered Species to human activities; (4) its status pursuant to CESA including legal protection, definition of 'take', recovery efforts, and penalties for violations; and (5) Project-specific protective measures described in this ITP. Permittee shall prepare and distribute wallet-sized cards or a fact sheet handout containing this information for workers to carry in the Project Area. Permittee shall provide interpretation and translation services for non-English-speaking workers. Upon completion of the program, employees shall sign a form stating they attended the program and understand all protection measures.
- 5.5. Construction Monitoring Documentation.** The Designated Biologist(s) shall maintain construction monitoring documentation on-site in either hard copy or digital format throughout the construction period, which shall include a copy of this ITP with attachments and a list of signatures of all personnel who have successfully completed the education program. Permittee shall ensure a copy of the construction monitoring documentation is available for review upon request by CDFW.
- 5.6. Trash Abatement.** Permittee shall initiate a trash abatement program before starting Covered Activities and shall continue the program for the duration of Covered Activities. Permittee shall ensure that trash and food items are contained in animal-proof containers. Permittee shall remove trash and food items ideally at daily intervals but at least once a week, to avoid attracting opportunistic predators such as ravens, coyotes, and feral dogs. Permittee shall remove all trash from the Project Area at the end of Covered Activities.
- 5.7. Dust Control.** Permittee shall implement dust control measures during Covered Activities to facilitate visibility for monitoring of the Covered Species by the Designated Biologist(s) and Designated Monitor(s). Permittee shall keep the amount of water used to the minimum amount needed and shall not allow water to

form puddles. Permittee shall not use dust palliatives in the Project Area without prior review of the chemical composition and written approval for use by CDFW.

- 5.8. Erosion Control Materials.** Permittee shall prohibit use of erosion control materials potentially harmful to Covered Species and other species, such as monofilament netting (erosion control matting) or similar material. This includes photodegradable or biodegradable synthetic netting, or other plastic erosion control materials. Permittee shall deploy erosion control fabric/mats, blankets, and/or fiber rolls consisting of only natural fibers such as jute, coconut, twine, or other similar fibers.
- 5.9. Delineation of Project Area Boundaries.** Before starting Covered Activities, Permittee shall clearly delineate the boundaries of the Project Area at the WHWTP site and raw water pump station with fencing, stakes, or flags. Permittee shall restrict all Covered Activities to within the fenced, staked, or flagged areas. Permittee shall maintain all fencing, stakes, and flags until the completion of Covered Activities.
- 5.10. Delineation of Habitat.** Before starting Covered Activities, Permittee shall clearly delineate Covered Species habitat adjacent to the Project Area with posted signs, posting stakes, flags, and/or rope or cord, and place fencing as necessary to minimize the disturbance of Covered Species habitat beyond the limits of the marked Project Area.
- 5.11. Project Access.** Project-related personnel shall access the Project Area using existing routes, or routes identified in the Project Description, and shall not cross Covered Species habitat outside of or en route to the Project Area. Permittee shall restrict Project-related vehicle traffic to established roads, staging, and parking areas. Permittee shall ensure that vehicle speeds do not exceed 20 miles per hour to avoid Covered Species on or traversing the roads. If Permittee determines construction of routes for travel are necessary outside of the Project Area, the Permittee or Designated Representative shall contact CDFW for written approval before carrying out such an activity. CDFW may require an amendment to this ITP, among other reasons, if additional take of Covered Species will occur as a result of the Project modification.
- 5.12. Staging Areas.** Permittee shall confine all Project-related parking, storage areas, stockpile areas, laydown sites, equipment storage, and any other surface-disturbing activities to the Project Area. Additionally, Permittee shall not use or cross Covered Species habitat outside of the Project Area unless provided for as described in accordance with Condition of Approval Project Access.
- 5.13. Hazardous Waste.** Permittee shall properly maintain all machinery to prevent spills and leaks of fuels, lubricants, or other fluids. Permittee shall immediately stop and pursuant to pertinent State and federal statutes and regulations, arrange for repair and clean up by qualified individuals of any fuel or hazardous waste leaks or spills

at the time of occurrence, or as soon as it is safe to do so. Permittee shall exclude the storage and handling of hazardous materials from the Project Area and shall properly contain and dispose of any unused or leftover hazardous products off site.

- 5.14. CDFW Access.** Permittee shall provide CDFW staff with reasonable access to the Project Area and shall otherwise fully cooperate with CDFW efforts to verify compliance with or effectiveness of this ITP's Conditions of Approval.
- 5.15. Refuse Removal.** Upon completion of Covered Activities, Permittee shall remove from the Project Area and properly dispose of all temporary fill and construction refuse, including, but not limited to, broken equipment parts, wrapping material, cords, cables, wire, rope, strapping, twine, buckets, metal or plastic containers, and boxes.

6. Monitoring, Notification and Reporting Provisions:

- 6.1. Notification Before Commencement.** The Designated Representative shall notify CDFW before starting Covered Activities and shall document compliance with all pre-Project Conditions of Approval before starting Covered Activities.
- 6.2. Notification of Non-compliance.** The Designated Representative shall immediately notify CDFW if the Permittee is not in compliance with any Condition of Approval of this ITP, including but not limited to any actual or anticipated failure to implement measures within the time periods indicated in this ITP and/or the MMRP. The Designated Representative and/or the Designated Biologist(s) shall follow up within 24 hours with a written report to CDFW describing, in detail, any non-compliance with this ITP and suggested measures to remedy the situation.
- 6.3. Geographic Information Systems Data Files.** Before starting Covered Activities, the Permittee shall provide CDFW with separate Geographic Information Systems (GIS) data files for the temporary and permanent habitat impact areas authorized under this ITP for the Project Area. If habitat for a Covered Species will be both temporarily and permanently impacted, the Permittee shall provide one set of GIS data files for each impact type. The Permittee shall provide any additional GIS data files for the Project or related Covered Species features within 30 days of CDFW's request. All GIS data files shall be provided in a format acceptable to CDFW.
- 6.4. Compliance Monitoring.** The Designated Biologist(s) shall be on-site daily to conduct compliance monitoring when Covered Activities occur. The Designated Biologist shall conduct compliance inspections to:
 - (1) minimize incidental take of the Covered Species;
 - (2) prevent unlawful take of species;
 - (3) check for compliance with all measures of this ITP;
 - (4) check all exclusion zones; and

- (5) ensure that signs, stakes, and fencing are intact, and that Covered Activities are only occurring in the Project Area.

The Designated Representative or Designated Biologist(s) shall prepare daily written observation and inspection records summarizing oversight activities and compliance inspections, observations of Covered Species and their sign, survey results, and monitoring activities required by this ITP. After initial ground disturbance (vegetation removal, clearing, grading, and excavation) are completed, the Designated Biologist(s) shall be on-site a minimum of once a week to conduct compliance inspections. In addition to the compliance inspections required by this Condition of Approval, the Designated Representative and Designated Biologist(s) shall ensure that all other inspections required by this ITP are conducted at the frequency (i.e., interval, time(s) of day, following weather events) required by other specific Conditions of Approval.

- 6.5. Quarterly Compliance Report (QCR).** Permittee shall submit Quarterly Compliance Reports (QCR) to CDFW by January 15, April 15, July 15, and October 15 of each year. The Designated Representative or Designated Biologist(s) shall compile the observation and inspection records required by Condition of Approval Compliance Monitoring for each quarter period into a QCR and submit it to CDFW along with a copy of the MMRP table with notes showing the current implementation status of each Condition of Approval. Each QCR shall also include: (1) an accounting of the number of acres that have been permanently and temporarily disturbed by the Project within the Project Area during the quarter period and the total since ITP issuance; (2) the number of acres of habitat disturbance anticipated to occur in the Project Area during the next quarter period, if applicable; (3) a summary of all Pre-Activity Clearance Surveys and compliance monitoring conducted during the quarter period; and (4) the activities authorized under the Covered Activities which occurred during the quarter period. Permittee shall submit QCRs to CDFW's Regional Office (R4CESA@wildlife.ca.gov), Headquarters CESA Program (CESA@wildlife.ca.gov), and Regional Representative (Stephanie.Manzo@wildlife.ca.gov) listed in the Notices section of this ITP. CDFW may at any time increase the timing and number of compliance inspections and reports required under this provision depending upon the results of previous compliance inspections. If CDFW determines the reporting schedule must be changed, CDFW will notify Permittee in writing of the new reporting schedule.
- 6.6. Annual Status Report (ASR).** Permittee shall submit Annual Status Reports (ASR) to CDFW no later than January 31 of each year beginning with issuance of this ITP and continuing until CDFW accepts the Final Mitigation Report identified below. Each ASR shall include, at a minimum: (1) a summary of all QCRs for the calendar year; (2) a general description of the status of the Project Area and Covered Activities, including actual or projected completion dates, if known; (3) a copy of the table in the MMRP with notes showing the current implementation status of each mitigation measure; (4) an assessment of the effectiveness of each completed or

partially completed mitigation measure in avoiding, minimizing and mitigating Project impacts; (5) all available information about Project-related incidental take of the Covered Species; (6) an accounting of the number of acres that have been permanently and temporarily disturbed during the calendar year and the total since ITP issuance; and (7) information about other Project impacts on the Covered Species. Permittee shall submit ASRs to CDFW's Regional Office, Headquarters CESA Program, and Regional Representative.

- 6.7. CNDDDB Observations.** The Designated Biologist(s) shall submit all observations of Covered Species to CDFW's California Natural Diversity Database (CNDDDB) within 60 calendar days of the observation. The Designated Biologist(s) shall include copies of the submitted forms with the next QCR or ASR, whichever is submitted first relative to the observation.
- 6.8. Final Mitigation Report.** No later than 45 days after completion of all mitigation measures, Permittee shall provide CDFW with a Final Mitigation Report. The Designated Biologist(s) shall prepare the Final Mitigation Report which shall include, at a minimum: (1) a summary of all QCRs and all ASRs; (2) a copy of the table in the MMRP with notes showing when each of the mitigation measures was implemented; (3) all available information about Project-related incidental take of the Covered Species; (4) information about other Project impacts on the Covered Species; (5) beginning and ending dates of Covered Activities; (6) an assessment of the effectiveness of this ITP's Conditions of Approval in minimizing and fully mitigating Project impacts of the taking on Covered Species; (7) recommendations on how mitigation measures might be changed to more effectively minimize take and mitigate the impacts of future projects on the Covered Species; (8) GIS data files depicting the total extent of permanent and temporary disturbance associated with the Project; and (9) any other pertinent information.
- 6.9. Notification of Take or Injury.** Permittee shall immediately notify the Designated Biologist(s) if a Covered Species is taken or injured by a Project-related activity, or if a Covered Species is otherwise found dead or injured within the Project vicinity. The Designated Biologist(s) or Designated Representative shall provide initial notification to CDFW by emailing the Regional Office (R4CESA@wildlife.ca.gov) and Regional Representative (Stephanie.Manzo@wildlife.ca.gov). The initial notification to CDFW shall include the ITP number and information regarding the location, species, number of animals taken or injured, and name of the CDFW-approved facility where the animal(s) was/were taken. Following initial notification, Permittee shall send a written report to CDFW's Regional Office, Headquarters CESA Program, and Regional Representative within two calendar days. The report shall include the date and time of the finding or incident, location of the animal(s) or carcass(es), and if possible, provide a photograph, explanation as to cause of take or injury, and any other pertinent information.

7. Take Minimization Measures: The following requirements are intended to ensure the minimization of incidental take of Covered Species in the Project Area during Covered Activities. Permittee shall implement and adhere to the following conditions to minimize take of Covered Species:

- 7.1. Covered Species Mortality Reduction and Relocation Plan.** Permittee shall prepare a Covered Species Mortality Reduction and Relocation Plan and submit it to CDFW for review and written approval before starting Covered Activities. The Covered Species Mortality Reduction and Relocation Plan shall include, but not be limited to, the following details: (1) discussion and map of locations within the Project Area which represent potential upland habitat; (2) discussion and map of locations within the Project Area within a) 630 meters and b) 2,092 meters of known or potential aquatic breeding habitat; (3) detailed survey, excavation, capture, handling, and relocation methods; (4) cover board check frequencies or removal based on seasonality and environmental conditions to ensure any cover boards that remain in use during the dry season (or dry periods) don't lead to risk of desiccation of the Covered Species; (5) identification of where salvaged Covered Species will be relocated to and a discussion of the biological suitability of the relocation site(s); (6) identification of a wildlife rehabilitation center or veterinary facility where injured Covered Species will be taken; and (7) detailed methods to ensure covers placed over holes, sumps, trenches, and other excavations form a complete seal around any pipes or other components and are secured to prevent gaps such that Covered Species are unable to squeeze under the cover in accordance with Condition of Approval Covers and Ramps. The Designated Monitor(s) are prohibited from capturing and handling Covered Species unless specifically approved in writing by CDFW and under the direct supervision of the Designated Biologist(s). Covered Activities may not proceed until a Covered Species Mortality Reduction and Relocation Plan is approved in writing by CDFW.
- 7.2. Covered Species Exclusion Fencing Plan.** Permittee shall prepare a Covered Species Exclusion Fencing Plan and submit it to CDFW for review and written approval before starting Covered Activities. The Covered Species Exclusion Fencing Plan shall include, but not be limited to the following details: (1) area(s) to be fenced (including maps); (2) fence materials; (3) fence design (e.g., height), layout (including maps), and installation methods; (4) cover boards to provide refuge areas for the Covered Species (include number of cover boards/spacing, material of cover boards, size of individual cover boards, cover board check frequencies based on seasonality, and locations); (5) specification of the maximum continuous linear length of fencing to be installed at any given time; and (6) inspection, maintenance, repair, and replacement methods and intervals. Permittee shall have a CDFW-approved Covered Species Exclusion Fencing Plan before implementing Conditions of Approval Covered Species Pre-Activity Clearance Surveying and Reporting, Flagging and Avoidance of Burrows and Crevices, Burrow and Crevice Excavation, and Covered Species Exclusion Fence Installation, below.

Incidental Take Permit
No. 2081-2024-024-04
SAN BENITO COUNTY WATER DISTRICT
WEST HILLS WATER TREATMENT PLANT EXPANSION

- 7.3. Covered Species Pre-Activity Clearance Surveying and Reporting.** The Designated Biologist(s) shall survey the Project Area for Covered Species no more than 14 days prior to conducting Covered Activities. Surveys shall provide 100 percent visual coverage (including burrows and crevices) within the Project Area and a 50-foot buffer zone around the Project Area if access allows. If Covered Species are found, the Designated Biologist(s) shall relocate Covered Species from the Project Area in accordance with the CDFW-approved Covered Species Mortality Reduction and Relocation Plan. Permittee shall provide the pre-activity clearance survey results to CDFW in a written report before starting Covered Activities.
- 7.4. Flagging and Avoidance of Burrows and Crevices.** During implementation of Condition of Approval Covered Species Pre-Activity Clearance Surveying and Reporting, the Designated Biologist(s) shall flag all animal burrows and crevices suitable for Covered Species occupancy within the Project Area and a 50-foot buffer zone around the Project Area if access allows. Burrows or crevices do not need to be flagged if they are located in areas outside of the Permittee's access and/or control. An avoidance buffer of 50 feet or greater around flagged burrows/crevices shall be maintained regardless of whether the burrow/crevice is in the Project Area or solely within the Project Area's 50-foot buffer zone. Flagged burrows/crevices which occur within 630 meters (0.4 miles) of known or potential Covered Species aquatic breeding habitat and which cannot be avoided by at least 50 feet shall be fully excavated in accordance with Condition of Approval Burrow and Crevice Excavation.
- 7.5. Burrow and Crevice Excavation.** Before starting Covered Activities, animal burrows and crevices flagged during implementation of Condition of Approval Covered Species Pre-Activity Clearance Surveying and Reporting shall be fully excavated if those burrows and crevices are within 630 meters (0.4 miles) of known or potential Covered Species aquatic breeding habitat and cannot be fully avoided by at least 50 feet. Excavation shall occur **no more than 14 days** after the completion of Covered Species Pre-Activity Clearance Surveying and Reporting and the flagging of burrows/crevices per Condition of Approval Flagging and Avoidance of Burrows and Crevices. Flagged burrows/crevices may be excavated by hand or in a manner otherwise approved by CDFW in accordance with the CDFW-approved Covered Species Mortality Reduction and Relocation Plan. Burrow/crevice excavation shall occur under the direct supervision of the Designated Biologist(s). The Designated Biologist(s) shall relocate any live Covered Species discovered during burrow/crevice excavation in accordance with the CDFW-approved Covered Species Mortality Reduction and Relocation Plan. Burrows and crevices identified outside of the Project Area shall be excavated if those burrows and crevices lie within 50 feet of Project ground- and/or vegetation disturbing activities. This excavation requirement applies regardless of whether the burrow/crevice is located within the Project Area or within the Project Area's 50-foot buffer zone except when the burrow/crevice is in an area outside of the Permittee's access and/or control.

- 7.6. Covered Species Exclusion Fence Installation.** After surveying, flagging, and excavating burrows/crevices in accordance with Conditions of Approval Covered Species Pre-Activity Clearance Surveying and Reporting, Flagging and Avoidance of Burrows and Crevices, and Burrow and Crevice Excavation, and after CDFW has approved the Covered Species Exclusion Fencing Plan, Permittee shall install Covered Species exclusion fencing before starting Covered Activities to prevent Covered Species from migrating into the cleared Project Area. The Covered Species exclusion fence shall be installed under the direct supervision of the Designated Biologist(s) and begin **no later than 48 hours after** burrow/crevice excavations and Covered Species relocation activities are complete. The Designated Biologist(s) shall accompany the exclusion fence installation crew to ensure that Covered Species are not killed or injured during fence installation. The Permittee shall avoid covering animal burrows and crevices during fence installation in accordance with Condition of Approval Flagging and Avoidance of Burrows and Crevices and not cover any burrows/crevices with any fencing material. When animal burrows and crevices that are within 630 meters of known or potential Covered Species aquatic breeding habitat cannot be avoided by a 50-foot no-disturbance buffer from the fence line, they shall be excavated as described in Condition of Approval Burrow and Crevice Excavation prior to commencing fence installation.
- 7.7. Vegetation Removal Along Existing Drying Beds/Graded Pads.** The Designated Biologist(s) shall be on-site daily during initial clearing activities along the perimeter of the existing drying beds and graded pads. Vegetation shall be removed incrementally, by hand/using hand tools to the maximum extent feasible from top to bottom, and power tool blades shall be set no lower than 4 inches to allow the Designated Biologist(s) 100 percent visual coverage to inspect the area under vegetation for any individuals of the Covered Species and burrows/crevices. If Covered Species or burrows/crevices are found, the Designated Biologist and Project workers shall immediately cease all Covered Activities in the vicinity. If Covered Species are found, the Designated Biologists(s) shall relocate Covered Species from the Project Area in accordance with the CDFW-approved Covered Species Mortality Reduction and Relocation Plan. If any burrows/crevices are found, the Designated Biologist shall implement burrow/crevice avoidance per Condition of Approval Flagging and Avoidance of Burrows and Crevices or excavate the burrow per Condition of Approval Burrow and Crevice Excavation. The Designated Biologist(s) shall move any detected Covered Species out of harm's way outside of the Project Area and in accordance with the CDFW-approved Covered Species Mortality Reduction and Relocation Plan.
- 7.8. Covered Species Exclusion Fence Inspection.** The Designated Biologist(s) shall check the Covered Species exclusion fence and cover boards daily during initial ground disturbance (vegetation removal, clearing, grading, and excavation) at the beginning of each workday. After initial ground disturbance and during periods of inactivity, the Designated Biologist(s) shall check the Covered Species exclusion

fence a minimum of once a week, daily following rain events, and frequencies in accordance with the CDFW approved Covered Species Mortality Reduction and Relocation Plan for cover board checks during the dry season. If Covered Species are found within the interior fence or underneath cover boards, the Designated Biologist(s) shall relocate them in accordance with the CDFW-approved Covered Species Mortality Reduction and Relocation Plan.

- 7.9.** Covered Species Exclusion Fence Repair and Removal. Permittee shall maintain and repair the Covered Species exclusion fence. Repairs shall be made within 48 hours of any discovery that repairs are necessary. Permittee shall ensure that the Covered Species exclusion fence remains in place and supported sufficiently to maintain its integrity under all conditions such as wind and heavy rain. Permittee shall remove all Covered Species exclusion fencing immediately upon completion of Covered Activities.
- 7.10.** Rain Forecast. The Permittee and Designated Biologist(s) shall monitor the National Weather Service 72-hour forecast for the Project Area. Permittee shall cease all Covered Activities in the Project Area where initial ground disturbance (vegetation removal, clearing, grading, and excavation) has yet to occur during rainfall and/or when a 50 percent or greater chance of rainfall is predicted within 72 hours. Permittee may continue Covered Activities 24 hours after rainfall ceases and there is a zero percent chance of rainfall in the 72-hour forecast. Where initial ground disturbance has already occurred, Permittee may continue Covered Activities during rainfall only if the Project Area has been previously disturbed and the Project Area (or areas approved by CDFW per the Covered Species Exclusion Fencing Plan) is surrounded by Covered Species exclusion fencing that is in effective condition and being properly maintained (see Condition of Approval Covered Species Exclusion Fence Installation).
- 7.11.** Stockpiles. Permittee shall ensure that soil stockpiles and materials are placed where soil, rocks, and quarried material will not pass into Covered Species aquatic breeding habitat, or into any other "Waters of the State". Permittee shall protect soil stockpiles appropriately to prevent soil erosion. Permittee shall stockpile all soil and materials in a manner that discourages Covered Species use including covering and/or elevating materials. Permittee shall not place soil stockpiles and materials outside of the Project Area.
- 7.12.** Open Excavations. The Designated Biologist(s) shall inspect all open holes, sumps, trenches, and other excavations daily and at the beginning of each day during initial ground disturbance (vegetation removal, clearing, grading, and excavation) for any Covered Species that may be trapped. The Designated Biologist(s) shall inspect all open holes, sumps, trenches, and other excavations for Covered Species immediately before they are temporarily or permanently backfilled. If any Project worker discovers that Covered Species have become trapped at any point, Project workers shall immediately cease all Covered Activities

in the vicinity which could cause further entrapment, or injure or kill the Covered Species, and notify the Designated Biologist(s). The Designated Biologist(s) and Project workers shall allow Covered Species to move to a safe location, unimpeded, if possible, before Covered Activities are allowed to continue. Alternatively, the Designated Biologist(s) may move Covered Species out of harm's way outside of the Project Area and in accordance with the CDFW-approved Covered Species Mortality Reduction and Relocation Plan.

- 7.13. Covers and Ramps.** Permittee shall ensure that all open holes, sumps, trenches, and other excavations are covered or escape ramps are provided to prevent inadvertent entrapment of Covered Species. At the end of each working day, Project workers shall cover all open holes, sumps, trenches, and other excavations of any depth that have sidewalls greater than 1:1 (45 degree) slope with barrier material (e.g., plywood). Permittee shall ensure the outer two feet of the cover conform to solid ground so that gaps do not occur between the cover and the ground. Permittee shall ensure covers form a complete seal around any pipes or other components and are secured to prevent gaps such that Covered Species are unable to squeeze under the cover. If any open holes, sumps, trenches, and other excavations cannot be covered, Permittee, in consultation with the Designated Biologist(s) shall provide at least one escape ramp constructed of earthen fill or a non-slip wooden plank with a less than 1:1 (45 degree) slope for each open hole, sump, trench, or other excavation. If a situation is encountered that this measure does not anticipate and alternative methods of preventing entrapment in open holes, sumps, trenches, and other excavations are warranted, Permittee shall request and obtain CDFW's written approval prior to implementing the alternative. The Designated Biologist(s) shall inspect the condition of covers and escape ramps to ensure that covers and ramps are in effective condition, secured, and do not have gaps.
- 7.14. Vehicle and Equipment Inspection.** Project workers shall inspect under vehicles and equipment for Covered Species before the start of each workday and before vehicles and equipment are moved for any Covered Species that may be utilizing the equipment as temporary shelter. If any Project worker discovers a Covered Species, the Project worker shall notify the Designated Biologist(s). Project workers and the Designated Biologist(s) shall allow the Covered Species to move to a safe location, if possible, before Covered Activities are allowed to continue. Alternatively, the Designated Biologist(s) may move the Covered Species out of harm's way outside of the Project Area and in accordance with the CDFW-approved Covered Species Mortality Reduction and Relocation Plan.
- 7.15. Pipes and Other Structures Entrapment Prevention.** Permittee shall ensure that all pipes, hoses, conduit, culverts, or similar materials stockpiled or installed in the Project Area are capped or otherwise enclosed at the ends to prevent entry by the Covered Species. Project workers shall thoroughly inspect all construction pipe, culverts, or other similar structures with a diameter of one inch or greater that are

stored for one or more overnight periods for Covered Species before the object is subsequently moved, buried, or capped. If during inspection, an individual of the Covered Species is discovered inside a pipe, culvert, or similar structure, the Project worker shall immediately cease all Covered Activities in the vicinity which could injure or kill the Covered Species and notify the Designated Biologist(s). Covered Species shall be allowed to escape unimpeded to a safe location, if possible, before Covered Activities are allowed to continue. Alternatively, the Designated Biologist(s) may move Covered Species out of harm's way outside of the Project Area and in accordance with the CDFW-approved Covered Species Mortality Reduction and Relocation Plan.

- 7.16. Covered Species Observations.** During all Covered Activities within the Project Area, Project workers shall inform the Designated Biologist(s) if a Covered Species is observed within or near the Project Area. All work in the vicinity of the observed Covered Species, which could injure or kill the animal, shall cease immediately until it moves from the Project Area of its own accord, or the Designated Biologist(s) relocates the Covered Species following the CDFW-approved Covered Species Mortality Reduction and Relocation Plan.
- 7.17. Record of Covered Species Handling and Relocation.** The Designated Biologist(s) shall maintain a record of all Covered Species handled and relocated. For each Covered Species handled and relocated, the Designated Biologist(s) shall report the following information: (1) date, time, and location (Global Positioning System (GPS) coordinates and maps) of capture and/or observation as well as release, if applicable; (2) the name of the party that identified the Covered Species; (3) circumstances of the incident; (4) the general condition and health, noting all visible conditions including gait and behavior, ectoparasites, injuries, etc.; (5) any diagnostic markings, sex, age (juvenile or adult); (6) actions undertaken; (7) habitat description; and (8) ambient temperature when handled, released, and or observed. Covered Species handling and relocation records shall be included in the required QCRs and ASRs. In addition, the Designated Biologist(s) shall submit this information to CDFW's CNDDDB required by Condition of Approval CNDDDB Observations.
- 7.18. Covered Species Injury.** If a Covered Species is injured as a result of Project-related activities, the Designated Biologist(s) shall immediately take it to the CDFW-approved wildlife rehabilitation or veterinary facility per the CDFW-approved Covered Species Mortality Reduction and Relocation Plan. Permittee shall bear any costs associated with the care or treatment of such injured Covered Species. The Designated Biologist(s) or Designated Representative shall notify CDFW of the injury to the Covered Species immediately by e-mail followed by a written incident report required by Condition of Approval Notification of Take or Injury.
- 7.19. Fieldwork Code of Practice.** The Designated Biologist(s) and Designated Monitor(s) shall follow the Fieldwork Code of Practice developed by the Declining Amphibian Populations Task Force at all times (see Attachment 3) to ensure that disease is

not conveyed outside of the Project Area. The Designated Biologist(s) and Designated Monitor(s) may substitute a bleach solution (0.5 to 1.0 cup of bleach to 1.0 gallon of water) for the ethanol solution.

8. Habitat Management Land Acquisition: CDFW has determined that permanent protection and perpetual management of compensatory habitat is necessary and required pursuant to CESA to fully mitigate Project-related impacts of the taking on the Covered Species that will result from implementation of the Covered Activities. This determination is based on factors including an assessment of the importance of the habitat in the Project Area, the extent to which the Covered Activities will impact the habitat, and CDFW's estimate of the protected acreage required to provide for adequate compensation.

The Permittee previously acquired 11 acres of Covered Species upland habitat credits from the Sparling Ranch Conservation Bank as required by CESA ITP No. 2081-2014-075-04 to fully mitigate for the permanent loss of 5.3 acres of upland habitat for the Covered Species and the temporary loss of 5.5 acres of upland habitat for the Covered Species resulting from the buildout of the 5.3-acre WHWTP. On August 31, 2017, the Permittee submitted a Bill of Sale and Payment Receipt to CDFW documenting acquisition of 11 acres of Covered Species upland habitat credits.

The Project's impact to 0.49 acres of Covered Species upland habitat were included in the impacts of the taking resulting from the 5.3-acre WHWTP project under ITP No. 2081-2014-075-04. Therefore, the impacts of the taking on the Covered Species resulting from this Project is considered fully mitigated through the Permittee's prior acquisition of 11 Covered Species upland credits.

IX. Amendment:

This ITP may be amended as provided by California Code of Regulations, Title 14, section 783.6, subdivision (c), and other applicable law. This ITP may be amended without the concurrence of the Permittee as required by law, including if CDFW determines that continued implementation of the Project as authorized under this ITP would jeopardize the continued existence of the Covered Species or where Project changes or changed biological conditions necessitate an ITP amendment to ensure that all Project-related impacts of the taking to the Covered Species are minimized and fully mitigated.

X. Stop-Work Order:

If CDFW determines the Permittee has violated any term or condition of this ITP or has engaged in unlawful take, CDFW may issue Permittee a written stop-work order instructing the Permittee to suspend any Covered Activity for an initial period of up to 30 days or risk suspension or revocation of this ITP. CDFW can issue a stop-work order to prevent or remedy a violation of this ITP, including but not limited to the failure to comply with reporting or monitoring obligations, or to prevent the unauthorized take of any CESA endangered, threatened, or candidate species, regardless of whether that species is a Covered Species under this ITP. Permittee shall stop work immediately as directed by CDFW upon receipt of any such stop-work order. Upon written notice to Permittee, CDFW may extend any stop-work order issued to Permittee for a period not to exceed 30 additional days.

Incidental Take Permit
No. 2081-2024-024-04
SAN BENITO COUNTY WATER DISTRICT
WEST HILLS WATER TREATMENT PLANT EXPANSION

If Permittee fails to remedy the violation or to comply with a stop-work order, CDFW may proceed with suspension and revocation of this ITP. Suspension and revocation of this ITP shall be governed by California Code of Regulations, Title 14, section 783.7, and any other applicable law. Neither the Designated Biologist nor CDFW shall be liable for any costs incurred in complying with stop-work orders.

XI. Compliance with Other Laws:

This ITP sets forth CDFW's requirements for the Permittee to implement the Project pursuant to CESA. This ITP does not necessarily create an entitlement to proceed with the Project. Permittee is responsible for complying with all other applicable federal, state, and local law.

XII. Notices:

Written notices, reports and other communications relating to this ITP shall be delivered to CDFW by email or registered first class mail at the following address, or at addresses CDFW may subsequently provide the Permittee. Notices, reports, and other communications shall reference the Project name, Permittee, and ITP Number (2081-2024-024-04) in a cover letter and on any other associated documents.

Original cover with attachment(s) to:

Julie A. Vance, Regional Manager
California Department of Fish and Wildlife
1234 East Shaw Avenue
Fresno, California 93710
(559) 243-4005
R4CESA@wildlife.ca.gov

and a copy to:

Habitat Conservation Planning Branch
California Department of Fish and Wildlife
Attention: CESA Permitting Program
Post Office Box 944209
Sacramento, California 94244-2090
CESA@wildlife.ca.gov

Unless Permittee is notified otherwise, CDFW's Regional Representative for purposes of addressing issues that arise during implementation of this ITP is:

Stephanie Manzo
California Department of Fish and Wildlife
1234 East Shaw Avenue
Fresno, California 93710
(559) 578-0409
Stephanie.Manzo@wildlife.ca.gov

Incidental Take Permit
No. 2081-2024-024-04
SAN BENITO COUNTY WATER DISTRICT
WEST HILLS WATER TREATMENT PLANT EXPANSION

XIII. Compliance with CEQA:

CDFW's issuance of this ITP is subject to CEQA. CDFW is a responsible agency pursuant to CEQA with respect to this ITP because of prior environmental review of the Project by the lead agency, San Benito County Water District. (See generally Pub. Resources Code, §§ 21067, 21069.) The lead agency's prior environmental review of the Project is set forth in the West Hills Water Treatment Plant Project Final Environmental Impact Report, (SCH No.: 2012081028) dated April 2014 that the San Benito County Water District certified for the West Hills Water Treatment Plant on April 30, 2014, and the Addendum to the Environmental Impact Report approved by San Benito County Water District on April 16, 2025. At the time the lead agency certified the EIR and approved the Project it also adopted various mitigation measures for the Covered Species as conditions of Project approval.

This ITP, along with CDFW's related CEQA findings, which are available as a separate document, provide evidence of CDFW's consideration of the lead agency's EIR for the Project and the environmental effects related to issuance of this ITP (CEQA Guidelines, § 15096, subd. (f)). CDFW finds that issuance of this ITP will not result in any previously undisclosed potentially significant effects on the environment or a substantial increase in the severity of any potentially significant environmental effects previously disclosed by the lead agency. Furthermore, to the extent the potential for such effects exists, CDFW finds adherence to and implementation of the Conditions of Project Approval adopted by the lead agency, and that adherence to and implementation of the Conditions of Approval imposed by CDFW through the issuance of this ITP, will avoid or reduce to below a level of significance any such potential effects. CDFW consequently finds that issuance of this ITP will not result in any significant, adverse impacts on the environment.

XIV. Findings Pursuant to CESA:

These findings are intended to document CDFW's compliance with the specific findings requirements set forth in CESA and related regulations. (Fish & G. Code § 2081, subs. (b)-(c); Cal. Code Regs., tit. 14, §§ 783.4, subds. (a)-(b), 783.5, subd. (c)(2).)

CDFW finds based on substantial evidence in the ITP application, the West Hills Water Treatment Plant Project Final Environmental Impact Report, the Addendum to the Environmental Impact Report, and the administrative record of proceedings, that issuance of this ITP complies and is consistent with the criteria governing the issuance of ITPs pursuant to CESA:

- (1) Take of Covered Species as defined in this ITP will be incidental to the otherwise lawful activities covered under this ITP;
- (2) Impacts of the taking on Covered Species will be minimized and fully mitigated through the implementation of measures required by this ITP and as described in the MMRP. Measures include: (1) permanent habitat protection; (2) establishment of avoidance zones; (3) worker education; and (4) Quarterly Compliance Reports. CDFW evaluated factors including an assessment of the importance of the habitat in the Project Area,

Incidental Take Permit
No. 2081-2024-024-04
SAN BENITO COUNTY WATER DISTRICT
WEST HILLS WATER TREATMENT PLANT EXPANSION

the extent to which the Covered Activities will impact the habitat, and CDFW's estimate of the acreage required to provide for adequate compensation. Based on this evaluation, CDFW determined that the protection and management in perpetuity of 11 acres of compensatory habitat that is contiguous with other protected Covered Species habitat and/or is of higher quality than the habitat being destroyed by the Project, along with the minimization, monitoring, reporting, and funding requirements of this ITP minimizes and fully mitigates the impacts of the taking caused by the Project;

- (3) The take avoidance and mitigation measures required pursuant to the conditions of this ITP and its attachments are roughly proportional in extent to the impacts of the taking authorized by this ITP;
- (4) The measures required by this ITP maintain Permittee's objectives to the greatest extent possible;
- (5) All required measures are capable of successful implementation;
- (6) This ITP is consistent with any regulations adopted pursuant to Fish and Game Code sections 2112 and 2114;
- (7) Permittee has ensured adequate funding to implement the measures required by this ITP as well as for monitoring compliance with, and the effectiveness of, those measures for the Project; and
- (8) Issuance of this ITP will not jeopardize the continued existence of the Covered Species based on the best scientific and other information reasonably available, and this finding includes consideration of the species' capability to survive and reproduce, and any adverse impacts of the taking on those abilities in light of (1) known population trends; (2) known threats to the species; and (3) reasonably foreseeable impacts on the species from other related projects and activities. Moreover, CDFW's finding is based, in part, on CDFW's express authority to amend the terms and conditions of this ITP without concurrence of the Permittee as necessary to avoid jeopardy and as required by law.

XV. Attachments:

FIGURE 1	Project Location
FIGURE 2	Project Site Components
FIGURE 3	Pump Station
FIGURE 4	Pipeline Excavation Diagram
FIGURE 5	Vegetation Removal
ATTACHMENT 1	Mitigation Monitoring and Reporting Program
ATTACHMENT 2	Biologist Resume Form
ATTACHMENT 3	Fieldwork Code of Practice

ISSUED BY THE CALIFORNIA DEPARTMENT OF FISH AND WILDLIFE ON 8/28/2025

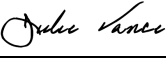
DocuSigned by:

FA83F09FE08945A...
Julie A. Vance, Regional Manager
Central Region

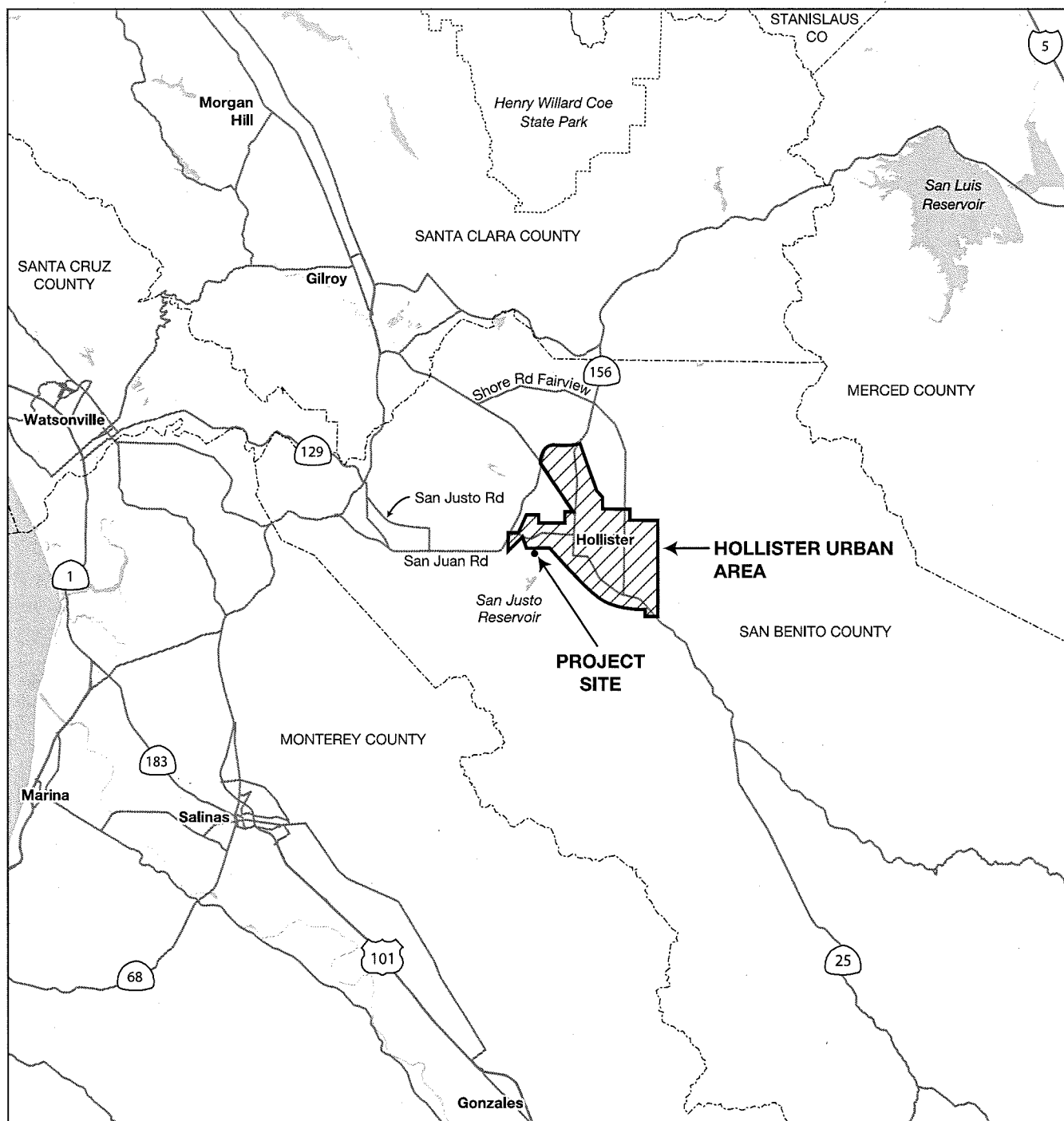
Incidental Take Permit
No. 2081-2024-024-04
SAN BENITO COUNTY WATER DISTRICT
WEST HILLS WATER TREATMENT PLANT EXPANSION



SOURCE: ESA

West Hills Water Treatment Plant . 211206

Figure 1
Project Location Map



60 0 60 US Feet



PROJECT SITE COMPONENTS

Figure 2



Figure 3. View of where the additional pump will be located in the existing pump station off of Union St.

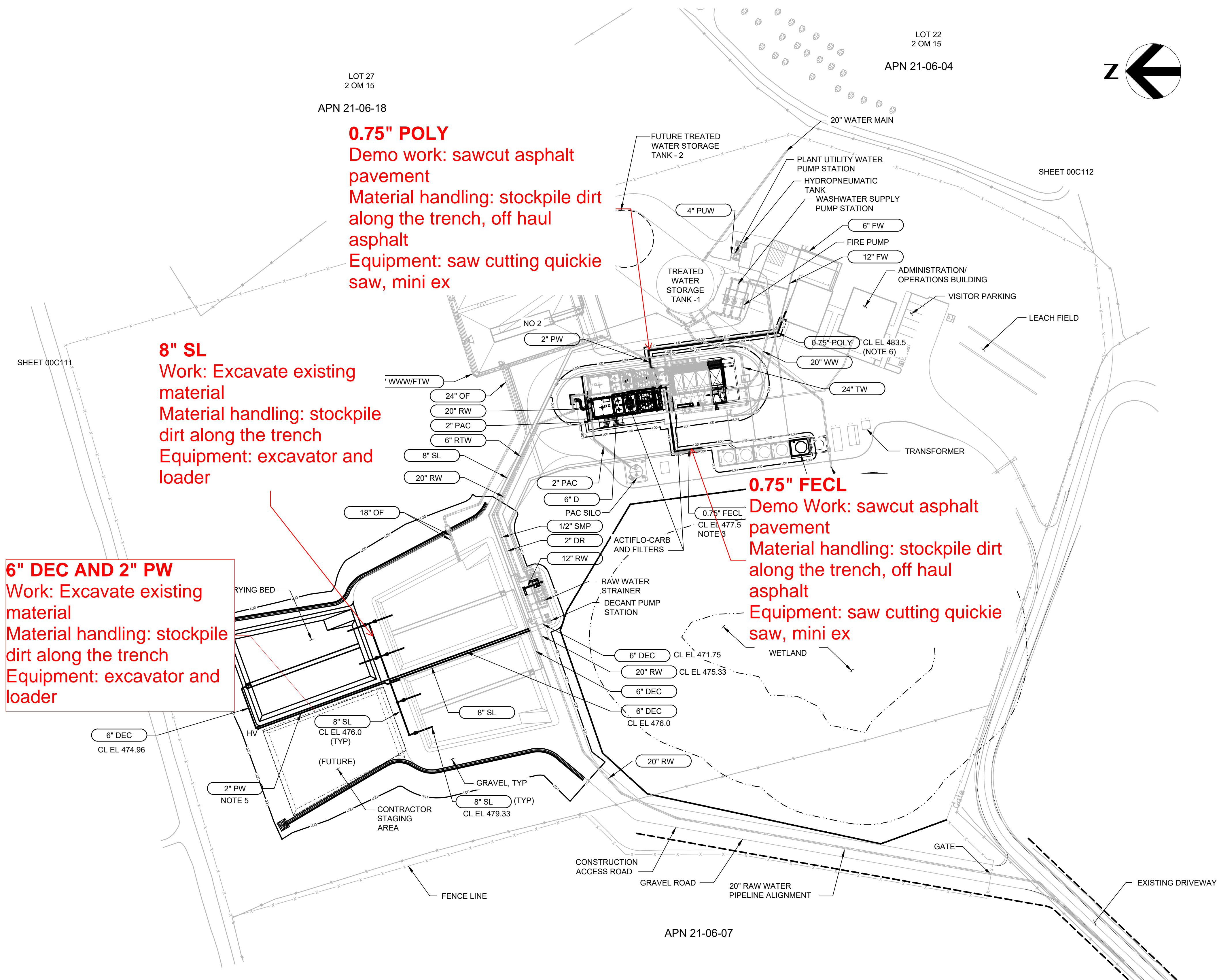
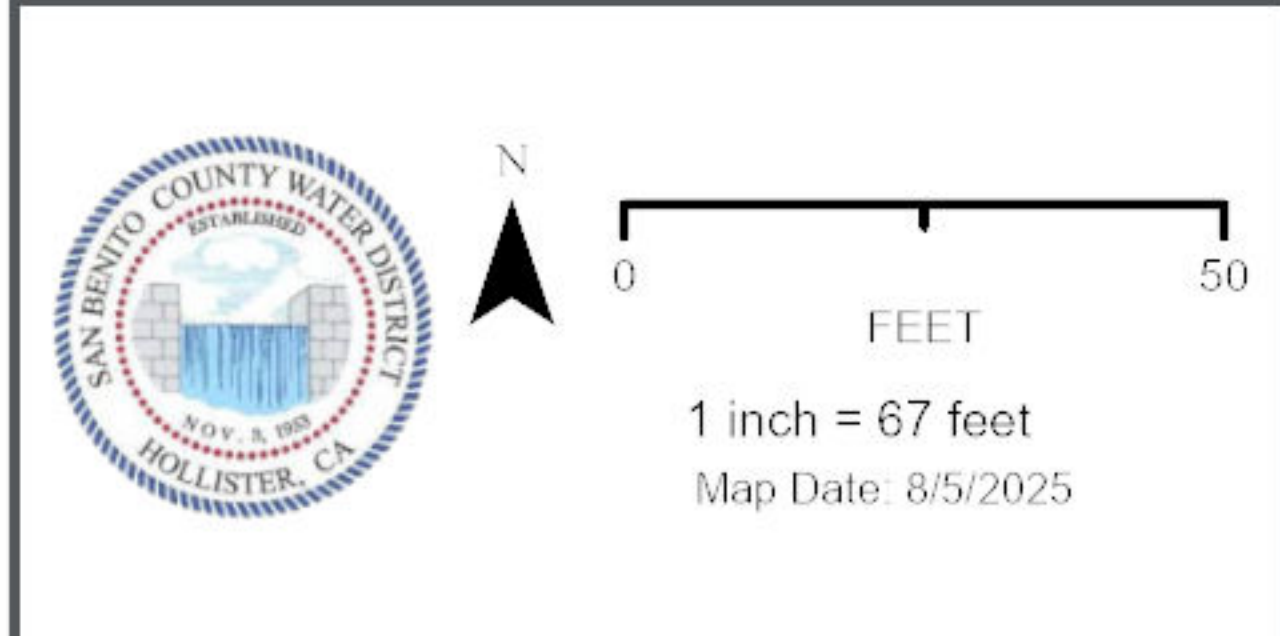

Figure 4. Pipeline Excavation Diagram



LEGEND	
Grassland	
	Permanent - 0.07 ac
	Temporary - 0.42 ac

Figure 5. VEGETATION REMOVAL
WEST HILLS WATER TREATMENT PLANT
ACCELERATED DROUGHT
RESPONSE PROJECT
SAN BENITO COUNTY WATER DISTRICT

Attachment 1

**CALIFORNIA DEPARTMENT OF FISH AND WILDLIFE
MITIGATION MONITORING AND REPORTING PROGRAM (MMRP)
CALIFORNIA ENDANGERED SPECIES ACT**

INCIDENTAL TAKE PERMIT NO. 2081-2024-024-04

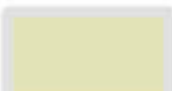
PERMITTEE: San Benito County Water District

PROJECT: West Hills Water Treatment Plant Expansion

PURPOSE OF THE MMRP

The purpose of the MMRP is to ensure that the impact minimization and mitigation measures required by the Department of Fish and Wildlife (CDFW) for the above-referenced Project are properly implemented, and thereby to ensure compliance with section 2081(b) of the Fish and Game Code and section 21081.6 of the Public Resources Code. A table summarizing the mitigation measures required by CDFW is attached. This table is a tool for use in monitoring and reporting on implementation of mitigation measures, but the descriptions in the table do not supersede the mitigation measures set forth in the California Incidental Take Permit (ITP) and in attachments to the ITP, and the omission of a permit requirement from the attached table does not relieve the Permittee of the obligation to ensure the requirement is performed.

OBLIGATIONS OF PERMITTEE

Mitigation measures must be implemented within the time periods indicated in the table that appears below. Permittee has the primary responsibility for monitoring compliance with all mitigation measures and for reporting to CDFW on the progress in implementing those measures. These monitoring and reporting requirements are set forth in the ITP itself and are summarized at the front of the attached table.

VERIFICATION OF COMPLIANCE, EFFECTIVENESS

CDFW may, at its sole discretion, verify compliance with any mitigation measure or independently assess the effectiveness of any mitigation measure.

TABLE OF MITIGATION MEASURES

The following items are identified for each mitigation measure: Mitigation Measure, Source, Implementation Schedule, Responsible Party, and Status/Date/Initials. The Mitigation Measure column summarizes the mitigation requirements of the ITP. The Source column identifies the ITP condition that sets forth the mitigation measure. The Implementation Schedule column shows the date or phase when each mitigation measure will be implemented. The Responsible Party column identifies the person or agency that is primarily responsible for implementing the mitigation measure. The Status/Date/Initials column shall be completed by the Permittee during preparation of each Status Report and the Final Mitigation Report and must identify the implementation status of each mitigation measure, the date that status was determined, and the initials of the person determining the status.

	Mitigation Measure	Source	Implementation Schedule	Responsible Party	Status / Date / Initials
BEFORE DISTURBING SOIL OR VEGETATION					
1	Before starting Covered Activities, Permittee shall designate a representative (Designated Representative) responsible for communications with CDFW and overseeing compliance with the ITP. Permittee shall notify CDFW (see Notices section below for contact information) in writing before starting Covered Activities of the Designated Representative's name, business address, and contact information, and shall notify CDFW in writing if a substitute Designated Representative is selected or identified at any time during the term of the ITP.	ITP Condition of Approval – Designated Representative	Before commencing ground- or vegetation-disturbing activities / Entire Project Notify CDFW in writing if/when a substitute Designated Representative is selected or identified	Permittee	
2	Before starting Covered Activities, Permittee shall submit to CDFW in writing the name, qualifications, business address, and contact information of the proposed Designated Biologist(s) using the Biologist Resume Form (Attachment 2) or another format containing the same information. Permittee shall review the qualifications of the proposed Designated Biologist(s) before submission to CDFW and ensure that the proposed Designated Biologist(s) is/are knowledgeable and experienced in the Covered Species' biology and natural history, collecting and handling of the Covered Species, excavating burrows and crevices to minimize mortality of Covered Species, and monitoring construction activities following the Conditions of Approval of an ITP for the Covered Species. Permittee shall obtain CDFW approval of the proposed Designated Biologist(s) in writing before starting Covered Activities. CDFW may approve Designated Monitors who do not meet the qualifications of a Designated Biologist, to assist the Designated Biologist(s) with compliance monitoring and/or implementation of specific Conditions of Approval. The responsibilities of the Designated Monitor(s) shall be restricted to specific Conditions of Approval, as specified by the Permittee or Designated Representative at the time their qualifications are submitted for review, and as approved by CDFW. Permittee shall submit to CDFW in writing the name, qualifications, business address, and contact information of the proposed Designated Monitor(s) using the Biologist Resume Form (Attachment 2) or another format containing the same information. Permittee shall obtain CDFW approval of the proposed Designated Monitor(s) in advance and in writing by CDFW, and shall also obtain approval in advance, in writing, if the Designated Biologist(s) or Designated Monitor(s) must be changed. The Designated Biologist(s) and Designated Monitor(s) shall be responsible for monitoring Covered Activities to help minimize or avoid the incidental take of individual Covered Species and to minimize disturbance of Covered Species' habitat.	ITP Condition of Approval – Designated Biologist(s)/ Designated Monitor(s)	Before commencing ground- or vegetation-disturbing activities / Entire Project Obtain CDFW approval in advance, in writing, if Designated Biologist(s) or Designated Monitor(s) must be changed	Permittee/ Designated Representative	

	Mitigation Measure	Source	Implementation Schedule	Responsible Party	Status / Date / Initials
3	Permittee shall conduct an education program for all persons employed or otherwise working in the Project Area before they can perform any work within the Project Area. Permittee shall provide the same instruction to any new workers before they are authorized to perform work in the Project Area. Permittee shall repeat this training at least once annually for long-term and/or permanent employees that will be conducting work in the Project Area. The program shall consist of a presentation from the Designated Biologist(s) that includes: (1) a discussion of the biology, life history, and general behavior of the Covered Species; (2) information about the distribution and habitat needs of the Covered Species; (3) sensitivity of the Covered Species to human activities; (4) its status pursuant to CESA including legal protection, definition of 'take', recovery efforts, and penalties for violations; and (5) Project-specific protective measures described in the ITP. Permittee shall prepare and distribute wallet-sized cards or a fact sheet handout containing this information for workers to carry in the Project Area. Permittee shall provide interpretation and translation services for non-English-speaking workers. Upon completion of the program, employees shall sign a form stating they attended the program and understand all protection measures.	ITP Condition of Approval – Education Program	Before commencing ground- or vegetation-disturbing activities / Entire Project	Permittee/ Designated Biologist	
4	Permittee shall initiate a trash abatement program before starting Covered Activities and shall continue the program for the duration of Covered Activities. Permittee shall ensure that trash and food items are contained in animal proof containers. Permittee shall remove trash and food items ideally at daily intervals but at least once a week, to avoid attracting opportunistic predators such as ravens, coyotes, and feral dogs. Permittee shall remove all trash from the Project Area at the end of Covered Activities.	ITP Condition of Approval – Trash Abatement	Before commencing ground- or vegetation-disturbing activities / Entire Project	Permittee	
5	Permittee shall initiate a trash abatement program before starting Covered Activities and shall continue the program for the duration of Covered Activities. Permittee shall ensure that trash and food items are contained in animal proof containers. Permittee shall remove trash and food items ideally at daily intervals but at least once a week, to avoid attracting opportunistic predators such as ravens, coyotes, and feral dogs. Permittee shall remove all trash from the Project Area at the end of Covered Activities.	ITP Condition of Approval – Delineation of Project Area Boundaries	Before commencing ground- or vegetation-disturbing activities / Entire Project	Permittee	
6	Before starting Covered Activities, Permittee shall clearly delineate Covered Species habitat adjacent to the Project Area with posted signs, posting stakes, flags, and/or rope or cord, and place fencing as necessary to minimize the disturbance of Covered Species habitat beyond the limits of the marked Project Area.	ITP Condition of Approval – Delineation of Habitat	Before commencing ground- or vegetation-disturbing activities / Entire Project	Permittee	
7	The Designated Representative shall notify CDFW before starting Covered Activities and shall document compliance with all pre-Project Conditions of Approval before starting Covered Activities.	ITP Condition of Approval – Notification Before Commencement	Before commencing ground- or vegetation-disturbing activities / Entire Project	Permittee/ Designated Representative	

	Mitigation Measure	Source	Implementation Schedule	Responsible Party	Status / Date / Initials
8	Before starting Covered Activities, the Permittee shall provide CDFW with separate Geographic Information Systems (GIS) data files for the temporary and permanent habitat impact areas authorized under the ITP for the Project Area. If habitat for a Covered Species will be both temporarily and permanently impacted, the Permittee shall provide one set of GIS data files for each impact type. The Permittee shall provide any additional GIS data files for the Project or related Covered Species features within 30 days of CDFW's request. All GIS data files shall be provided in a format acceptable to CDFW.	ITP Condition of Approval – Geographic Information Systems Data Files	Before commencing ground- or vegetation-disturbing activities / Entire Project	Permittee	
9	Permittee shall prepare a Covered Species Mortality Reduction and Relocation Plan and submit it to CDFW for review and written approval before starting Covered Activities. The Covered Species Mortality Reduction and Relocation Plan shall include, but not be limited to, the following details: (1) discussion and map of locations within the Project Area which represent potential upland habitat; (2) discussion and map of locations within the Project Area within a) 630 meters and b) 2,092 meters of known or potential aquatic breeding habitat; (3) detailed survey, excavation, capture, handling, and relocation methods; (4) cover board check frequencies or removal based on seasonality and environmental conditions to ensure any cover boards that remain in use during the dry season (or dry periods) don't lead to risk of desiccation of the Covered Species; (5) identification of where salvaged Covered Species will be relocated to and a discussion of the biological suitability of the relocation site(s); (6) identification of a wildlife rehabilitation center or veterinary facility where injured Covered Species will be taken; and (7) detailed methods to ensure covers placed over holes, sumps, trenches, and other excavations form a complete seal around any pipes or other components and are secured to prevent gaps such that Covered Species are unable to squeeze under the cover in accordance with Condition of Approval <u>Covers and Ramps</u> . The Designated Monitor(s) are prohibited from capturing and handling Covered Species unless specifically approved in writing by CDFW and under the direct supervision of the Designated Biologist(s). Covered Activities may not proceed until a Covered Species Mortality Reduction and Relocation Plan is approved in writing by CDFW.	ITP Condition of Approval – Covered Species Mortality Reduction and Relocation Plan	Before commencing ground- or vegetation-disturbing activities	Permittee	
10	Permittee shall prepare a Covered Species Exclusion Fencing Plan and submit it to CDFW for review and written approval before starting Covered Activities. The Covered Species Exclusion Fencing Plan shall include, but not be limited to the following details: (1) area(s) to be fenced (including maps); (2) fence materials; (3) fence design (e.g., height), layout (including maps), and installation methods; (4) cover boards to provide refuge areas for the Covered Species (include number of cover boards/spacing, material of cover boards, size of individual cover boards, cover board check frequencies based on seasonality, and locations); (5) specification of the maximum continuous linear length of fencing to be installed at any given time; and (6) inspection, maintenance, repair, and replacement methods and intervals. Permittee shall have a CDFW-approved Covered Species Exclusion Fencing Plan before implementing Conditions of Approval <u>Covered Species Pre-Activity Clearance Surveying and Reporting</u> , <u>Flagging and Avoidance of Burrows and Crevices</u> , <u>Burrow and Crevice Excavation</u> , and <u>Covered Species Exclusion Fence Installation</u> , below.	ITP Condition of Approval – Covered Species Exclusion Fencing Plan	Before commencing ground- or vegetation-disturbing activities	Permittee	

	Mitigation Measure	Source	Implementation Schedule	Responsible Party	Status / Date / Initials
11	The Designated Biologist(s) shall survey the Project Area for Covered Species no more than 14 days prior to conducting Covered Activities. Surveys shall provide 100 percent visual coverage (including burrows and crevices) within the Project Area and a 50 foot buffer zone around the Project Area if access allows. If Covered Species are found, the Designated Biologists(s) shall relocate Covered Species from the Project Area in accordance with the CDFW-approved <u>Covered Species Mortality Reduction and Relocation Plan</u> . Permittee shall provide the pre-activity clearance survey results to CDFW in a written report before starting Covered Activities.	ITP Condition of Approval – Covered Species Pre-Activity Clearance Surveying and Reporting	No more than 14 days prior to conducting Covered Activities Provide the pre-activity clearance survey results to CDFW in a written report before starting Covered Activities	Permittee/ Designated Biologist	
12	During implementation of Condition of Approval <u>Covered Species Pre-Activity Clearance Surveying and Reporting</u> , the Designated Biologist(s) shall flag all animal burrows and crevices suitable for Covered Species occupancy within the Project Area and a 50-foot buffer zone around the Project Area if access allows. Burrows or crevices do not need to be flagged if they are located in areas outside of the Permittee's access and/or control. An avoidance buffer of 50 feet or greater around flagged burrows/crevices shall be maintained regardless of whether the burrow/crevice is in the Project Area or solely within the Project Area's 50-foot buffer zone. Flagged burrows/crevices which occur within 630 meters (0.4 miles) of known or potential Covered Species aquatic breeding habitat and which cannot be avoided by at least 50 feet shall be fully excavated in accordance with Condition of Approval <u>Burrow and Crevice Excavation</u> .	ITP Condition of Approval – Flagging and Avoidance of Burrows and Crevices	No more than 14 days prior to conducting Covered Activities During Covered Species Pre-Activity Clearance Surveys	Permittee/ Designated Biologist	
13	Before starting Covered Activities, animal burrows and crevices flagged during implementation of Condition of Approval <u>Covered Species Pre-Activity Clearance Surveying and Reporting</u> shall be fully excavated if those burrows and crevices are within 630 meters (0.4 miles) of known or potential Covered Species aquatic breeding habitat and cannot be fully avoided by at least 50 feet. Excavation shall occur no more than 14 days after the completion of <u>Covered Species Pre-Activity Clearance Surveying and Reporting</u> and the flagging of burrows/crevices per Condition of Approval <u>Flagging and Avoidance of Burrows and Crevices</u> . Flagged burrows/crevices may be excavated by hand or in a manner otherwise approved by CDFW in accordance with the CDFW-approved <u>Covered Species Mortality Reduction and Relocation Plan</u> . Burrow/crevice excavation shall occur under the direct supervision of the Designated Biologist(s). The Designated Biologist(s) shall relocate any live Covered Species discovered during burrow/crevice excavation in accordance with the CDFW-approved <u>Covered Species Mortality Reduction and Relocation Plan</u> . Burrows and crevices identified outside of the Project Area shall be excavated if those burrows and crevices lie within 50 feet of Project ground- and/or vegetation disturbing activities. This excavation requirement applies regardless of whether the burrow/crevice is located within the Project Area or within the Project Area's 50-foot buffer zone except when the burrow/crevice is in an area outside of the Permittee's access and/or control.	ITP Condition of Approval – Burrow and Crevice Excavation	Before commencing ground- or vegetation-disturbing activities Excavation shall occur no more than 14 days after the completion of the Covered Species Pre-Activity Clearance Surveys and flagging of burrows/crevices	Permittee/ Designated Biologist	

	Mitigation Measure	Source	Implementation Schedule	Responsible Party	Status / Date / Initials
14	After surveying, flagging, and excavating burrows/crevices in accordance with Conditions of Approval <u>Covered Species Pre-Activity Clearance Surveying and Reporting, Flagging and Avoidance of Burrows and Crevices</u> , and <u>Burrow and Crevice Excavation</u> , and after CDFW has approved the <u>Covered Species Exclusion Fencing Plan</u> , Permittee shall install Covered Species exclusion fencing before starting Covered Activities to prevent Covered Species from migrating into the cleared Project Area. The Covered Species exclusion fence shall be installed under the direct supervision of the Designated Biologist(s) and begin no later than 48 hours after burrow/crevice excavations and Covered Species relocation activities are complete. The Designated Biologist(s) shall accompany the exclusion fence installation crew to ensure that Covered Species are not killed or injured during fence installation. The Permittee shall avoid covering animal burrows and crevices during fence installation in accordance with Condition of Approval <u>Flagging and Avoidance of Burrows and Crevices</u> and not cover any burrows/crevices with any fencing material. When animal burrows and crevices that are within 630 meters of known or potential Covered Species aquatic breeding habitat cannot be avoided by a 50-foot no-disturbance buffer from the fence line, they shall be excavated as described in Condition of Approval <u>Burrow and Crevice Excavation</u> prior to commencing fence installation.	ITP Condition of Approval – Exclusion Fence Installation	Before commencing ground- or vegetation-disturbing activities No later than 48 hours after burrow/crevice excavations and Covered Species relocation activities are complete	Permittee/ Designated Biologist	
DURING CONSTRUCTION					
15	To ensure compliance with the Conditions of Approval of the ITP, the Designated Biologist(s) and Designated Monitor(s) shall immediately stop any activity that does not comply with the ITP and/or order any reasonable measure to avoid the unauthorized take of an individual of the Covered Species. Permittee shall provide unfettered access to the Project Area and otherwise facilitate the Designated Biologist(s) and Designated Monitor(s) in the performance of their duties. If the Designated Biologist(s) and/or Designated Monitor(s) are unable to comply with the ITP, then the Designated Biologist(s) and/or Designated Monitor(s) shall notify the CDFW Regional Representative (detailed in the Notices section below) immediately. Permittee shall not enter into any agreement or contract of any kind, including but not limited to non-disclosure agreements and confidentiality agreements, with its contractors and/or the Designated Biologist(s)/Designated Monitor(s) that prohibit or impede open communication with CDFW, including but not limited to providing CDFW staff with the results of any surveys, reports, or studies or notifying CDFW of any non-compliance or take. Failure to notify CDFW of any non-compliance or take or injury of a Covered Species as a result of such agreement or contract may result in CDFW taking actions to prevent or remedy a violation of the ITP.	ITP Condition of Approval – Designated Biologist and Designated Monitor Authority	Entire Project	Permittee/ Designated Biologist	
16	The Designated Biologist(s) shall maintain construction monitoring documentation on-site in either hard copy or digital format throughout the construction period, which shall include a copy of the ITP with attachments and a list of signatures of all personnel who have successfully completed the education program. Permittee shall ensure a copy of the construction monitoring documentation is available for review upon request by CDFW.	ITP Condition of Approval – Construction Monitoring Documentation	Entire Project	Permittee/ Designated Biologist	
17	Permittee shall implement dust control measures during Covered Activities to facilitate visibility for monitoring of the Covered Species by the Designated Biologist(s) and Designated Monitor(s). Permittee shall keep the amount of water used to the minimum amount needed and shall not allow water to form puddles. Permittee shall not use dust palliatives in the Project Area without prior review of the chemical composition and written approval for use by CDFW.	ITP Condition of Approval – Dust Control	Entire Project	Permittee	

	Mitigation Measure	Source	Implementation Schedule	Responsible Party	Status / Date / Initials
18	Permittee shall prohibit use of erosion control materials potentially harmful to Covered Species and other species, such as monofilament netting (erosion control matting) or similar material. This includes photodegradable or biodegradable synthetic netting, or other plastic erosion control materials. Permittee shall deploy erosion control fabric/mats, blankets, and/or fiber rolls consisting of only natural fibers such as jute, coconut, twine, or other similar fibers.	ITP Condition of Approval – Erosion Control Materials	Entire Project	Permittee	
19	Project-related personnel shall access the Project Area using existing routes, or routes identified in the Project Description, and shall not cross Covered Species habitat outside of or en route to the Project Area. Permittee shall restrict Project-related vehicle traffic to established roads, staging, and parking areas. Permittee shall ensure that vehicle speeds do not exceed 20 miles per hour to avoid Covered Species on or traversing the roads. If Permittee determines construction of routes for travel are necessary outside of the Project Area, the Permittee or Designated Representative shall contact CDFW for written approval before carrying out such an activity. CDFW may require an amendment to the ITP, among other reasons, if additional take of Covered Species will occur as a result of the Project modification.	ITP Condition of Approval – Project Access	Entire Project	Permittee	
20	Permittee shall confine all Project-related parking, storage areas, stockpile areas, laydown sites, equipment storage, and any other surface-disturbing activities to the Project Area. Additionally, Permittee shall not use or cross Covered Species habitat outside of the Project Area unless provided for as described in accordance with Condition of Approval <u>Project Access</u> .	ITP Condition of Approval – Staging Areas	Entire Project	Permittee	
21	Permittee shall properly maintain all machinery to prevent spills and leaks of fuels, lubricants, or other fluids. Permittee shall immediately stop and pursuant to pertinent State and federal statutes and regulations, arrange for repair and clean up by qualified individuals of any fuel or hazardous waste leaks or spills at the time of occurrence, or as soon as it is safe to do so. Permittee shall exclude the storage and handling of hazardous materials from the Project Area and shall properly contain and dispose of any unused or leftover hazardous products off site.	ITP Condition of Approval – Hazardous Waste	Entire Project	Permittee	
22	Permittee shall provide CDFW staff with reasonable access to the Project Area and shall otherwise fully cooperate with CDFW efforts to verify compliance with or effectiveness of the ITP's Conditions of Approval.	ITP Condition of Approval – CDFW Access	Entire Project	Permittee	
23	The Designated Representative shall immediately notify CDFW if the Permittee is not in compliance with any Condition of Approval of the ITP, including but not limited to any actual or anticipated failure to implement measures within the time periods indicated in the ITP and/or this MMRP. The Designated Representative and/or the Designated Biologist(s) shall follow up within 24 hours with a written report to CDFW describing, in detail, any non-compliance with the ITP and suggested measures to remedy the situation.	ITP Condition of Approval – Notification of Non-compliance	Entire Project	Permittee/ Designated Representative/ Designated Biologist	

	Mitigation Measure	Source	Implementation Schedule	Responsible Party	Status / Date / Initials
24	<p>The Designated Biologist(s) shall be on-site daily to conduct compliance monitoring when Covered Activities occur. The Designated Biologist shall conduct compliance inspections to:</p> <ol style="list-style-type: none"> (1) minimize incidental take of the Covered Species; (2) prevent unlawful take of species; (3) check for compliance with all measures of the ITP; (4) check all exclusion zones; and (5) ensure that signs, stakes, and fencing are intact, and that Covered Activities are only occurring in the Project Area. <p>The Designated Representative or Designated Biologist(s) shall prepare daily written observation and inspection records summarizing oversight activities and compliance inspections, observations of Covered Species and their sign, survey results, and monitoring activities required by the ITP. After initial ground disturbance (vegetation removal, clearing, grading, and excavation) are completed, the Designated Biologist(s) shall be on-site a minimum of once a week to conduct compliance inspections. In addition to the compliance inspections required by this Condition of Approval, the Designated Representative and Designated Biologist(s) shall ensure that all other inspections required by the ITP are conducted at the frequency (i.e., interval, time(s) of day, following weather events) required by other specific Conditions of Approval.</p>	ITP Condition of Approval – Compliance Monitoring	<p>Entire Project</p> <p>On-site daily</p> <p>A minimum of once a week after initial ground disturbance (vegetation removal, clearing, grading, and excavation) are completed</p>	Permittee/ Designated Biologist	
25	<p>Permittee shall submit Quarterly Compliance Reports (QCR) to CDFW by January 15, April 15, July 15, and October 15 of each year. The Designated Representative or Designated Biologist(s) shall compile the observation and inspection records required by Condition of Approval <u>Compliance Monitoring</u> for each quarter period into a QCR and submit it to CDFW along with a copy of this MMRP table with notes showing the current implementation status of each Condition of Approval. Each QCR shall also include: (1) an accounting of the number of acres that have been permanently and temporarily disturbed by the Project within the Project Area during the quarter period and the total since ITP issuance; (2) the number of acres of habitat disturbance anticipated to occur in the Project Area during the next quarter period, if applicable; (3) a summary of all Pre-Activity Clearance Surveys and compliance monitoring conducted during the quarter period; and (4) the activities authorized under the Covered Activities which occurred during the quarter period. Permittee shall submit QCRs to CDFW's Regional Office (R4CESA@wildlife.ca.gov), Headquarters CESA Program (CESA@wildlife.ca.gov), and Regional Representative (Stephanie.Manzo@wildlife.ca.gov) listed in the Notices section of the ITP. CDFW may at any time increase the timing and number of compliance inspections and reports required under this provision depending upon the results of previous compliance inspections. If CDFW determines the reporting schedule must be changed, CDFW will notify Permittee in writing of the new reporting schedule.</p>	ITP Condition of Approval – Quarterly Compliance Report (QCR)	<p>Entire Project</p> <p>By January 15, April 15, July 15, and October 15 of each year</p>	Permittee	

	Mitigation Measure	Source	Implementation Schedule	Responsible Party	Status / Date / Initials
26	Permittee shall submit Annual Status Reports (ASR) to CDFW no later than January 31 of each year beginning with issuance of the ITP and continuing until CDFW accepts the <u>Final Mitigation Report</u> identified below. Each ASR shall include, at a minimum: (1) a summary of all <u>QCRs</u> for the calendar year; (2) a general description of the status of the Project Area and Covered Activities, including actual or projected completion dates, if known; (3) a copy of the table in this MMRP with notes showing the current implementation status of each mitigation measure; (4) an assessment of the effectiveness of each completed or partially completed mitigation measure in avoiding, minimizing and mitigating Project impacts; (5) all available information about Project-related incidental take of the Covered Species; (6) an accounting of the number of acres that have been permanently and temporarily disturbed during the calendar year and the total since ITP issuance; and (7) information about other Project impacts on the Covered Species. Permittee shall submit ASRs to CDFW's Regional Office, Headquarters CESA Program, and Regional Representative.	ITP Condition of Approval – Annual Status Report	Entire Project No later than January 31 of each year	Permittee	
27	The Designated Biologist(s) shall submit all observations of Covered Species to CDFW's California Natural Diversity Database (CNDDDB) within 60 calendar days of the observation. The Designated Biologist(s) shall include copies of the submitted forms with the next <u>QCR</u> or <u>ASR</u> , whichever is submitted first relative to the observation.	ITP Condition of Approval – CNDDDB Observations	Entire Project Within 60 calendar days of the observation	Permittee/ Designated Biologist	
28	Permittee shall immediately notify the Designated Biologist(s) if a Covered Species is taken or injured by a Project-related activity, or if a Covered Species is otherwise found dead or injured within the Project vicinity. The Designated Biologist(s) or Designated Representative shall provide initial notification to CDFW by emailing the Regional Office (R4CESA@wildlife.ca.gov) and Regional Representative (Stephanie.Manzo@wildlife.ca.gov). The initial notification to CDFW shall include the ITP number and information regarding the location, species, number of animals taken or injured, and name of the CDFW-approved facility where the animal(s) was/were taken. Following initial notification, Permittee shall send a written report to CDFW's Regional Office, Headquarters CESA Program, and Regional Representative within two calendar days. The report shall include the date and time of the finding or incident, location of the animal(s) or carcass(es), and if possible, provide a photograph, explanation as to cause of take or injury, and any other pertinent information.	ITP Condition of Approval – Notification of Take or Injury	Entire Project	Permittee/ Designated Biologist	

	Mitigation Measure	Source	Implementation Schedule	Responsible Party	Status / Date / Initials
29	The Designated Biologist(s) shall be on-site daily during initial clearing activities along the perimeter of the existing drying beds and graded pads. Vegetation shall be removed incrementally, by hand/using hand tools to the maximum extent feasible from top to bottom, and power tool blades shall be set no lower than 4 inches to allow the Designated Biologist(s) 100 percent visual coverage to inspect the area under vegetation for any individuals of the Covered Species and burrows/crevices. If Covered Species or burrows/crevices are found, the Designated Biologist and Project workers shall immediately cease all Covered Activities in the vicinity. If Covered Species are found, the Designated Biologists(s) shall relocate Covered Species from the Project Area in accordance with the CDFW-approved <u>Covered Species Mortality Reduction and Relocation Plan</u> . If any burrows/crevices are found, the Designated Biologist shall implement burrow/crevice avoidance per Condition of Approval <u>Flagging and Avoidance of Burrows and Crevices</u> or excavate the burrow per Condition of Approval <u>Burrow and Crevice Excavation</u> . The Designated Biologist(s) shall move any detected Covered Species out of harm's way outside of the Project Area and in accordance with the CDFW-approved <u>Covered Species Mortality Reduction and Relocation Plan</u> .	ITP Condition of Approval – Vegetation Removal Along Existing Drying Beds/Graded Pads	During Vegetation Removal	Permittee/ Designated Biologist	
30	The Designated Biologist(s) shall check the Covered Species exclusion fence and cover boards daily during initial ground disturbance (vegetation removal, clearing, grading, and excavation) at the beginning of each workday. After initial ground disturbance and during periods of inactivity, the Designated Biologist(s) shall check the Covered Species exclusion fence a minimum of once a week, daily following rain events, and frequencies in accordance with the CDFW approved <u>Covered Species Mortality Reduction and Relocation Plan</u> for cover board checks during the dry season. If Covered Species are found within the interior fence or underneath cover boards, the Designated Biologist(s) shall relocate them in accordance with the CDFW-approved <u>Covered Species Mortality Reduction and Relocation Plan</u> .	ITP Condition of Approval – Covered Species Exclusion Fence Inspection	Entire Project Daily A minimum of once a week after initial ground disturbance and during periods of inactivity, daily following rain events, and frequencies in accordance with the CDFW-approved Covered Species Mortality Reduction and Relocation Plan for cover board checks during the dry season	Permittee/ Designated Biologist	
31	Permittee shall maintain and repair the Covered Species exclusion fence. Repairs shall be made within 48 hours of any discovery that repairs are necessary. Permittee shall ensure that the Covered Species exclusion fence remains in place and supported sufficiently to maintain its integrity under all conditions such as wind and heavy rain. Permittee shall remove all Covered Species exclusion fencing immediately upon completion of Covered Activities.	ITP Condition of Approval – Covered Species Exclusion Fence Repair and Removal	Entire Project Repairs within 48 hours of discovery	Permittee	

	Mitigation Measure	Source	Implementation Schedule	Responsible Party	Status / Date / Initials
32	The Permittee and Designated Biologist(s) shall monitor the National Weather Service 72-hour forecast for the Project Area. Permittee shall cease all Covered Activities in the Project Area where initial ground disturbance (vegetation removal, clearing, grading, and excavation) has yet to occur during rainfall and/or when a 50 percent or greater chance of rainfall is predicted within 72 hours. Permittee may continue Covered Activities 24 hours after rainfall ceases and there is a zero percent chance of rainfall in the 72-hour forecast. Where initial ground disturbance has already occurred, Permittee may continue Covered Activities during rainfall only if the Project Area has been previously disturbed <u>and</u> the Project Area (or areas approved by CDFW per the <u>Covered Species Exclusion Fencing Plan</u>) is surrounded by Covered Species exclusion fencing that is in effective condition and being properly maintained (see Condition of Approval <u>Covered Species Exclusion Fence Installation</u>).	ITP Condition of Approval – Rain Forecast	Entire Project	Permittee/ Designated Biologist	
33	Permittee shall ensure that soil stockpiles and materials are placed where soil, rocks, and quarried material will not pass into Covered Species aquatic breeding habitat, or into any other “Waters of the State”. Permittee shall protect soil stockpiles appropriately to prevent soil erosion. Permittee shall stockpile all soil and materials in a manner that discourages Covered Species use including covering and/or elevating materials. Permittee shall not place soil stockpiles and materials outside of the Project Area.	ITP Condition of Approval – Stockpiles	Entire Project	Permittee	
34	The Designated Biologist(s) shall inspect all open holes, sumps, trenches, and other excavations daily and at the beginning of each day during initial ground disturbance (vegetation removal, clearing, grading, and excavation) for any Covered Species that may be trapped. The Designated Biologist(s) shall inspect all open holes, sumps, trenches, and other excavations for Covered Species immediately before they are temporarily or permanently backfilled. If any Project worker discovers that Covered Species have become trapped at any point, Project workers shall immediately cease all Covered Activities in the vicinity which could cause further entrapment, or injure or kill the Covered Species, and notify the Designated Biologist(s). The Designated Biologist(s) and Project workers shall allow Covered Species to move to a safe location, unimpeded, if possible, before Covered Activities are allowed to continue. Alternatively, the Designated Biologist(s) may move Covered Species out of harm’s way outside of the Project Area and in accordance with the CDFW-approved <u>Covered Species Mortality Reduction and Relocation Plan</u> .	ITP Condition of Approval – Open Excavations	Entire Project Daily during initial ground disturbance Immediately before open holes, sumps, trenches, and other excavations are backfilled	Permittee/ Designated Biologist	

	Mitigation Measure	Source	Implementation Schedule	Responsible Party	Status / Date / Initials
35	Permittee shall ensure that all open holes, sumps, trenches, and other excavations are covered or escape ramps are provided to prevent inadvertent entrapment of Covered Species. At the end of each working day, Project workers shall cover all open holes, sumps, trenches, and other excavations of any depth that have sidewalls greater than 1:1 (45 degree) slope with barrier material (e.g., plywood). Permittee shall ensure the outer two feet of the cover conform to solid ground so that gaps do not occur between the cover and the ground. Permittee shall ensure covers form a complete seal around any pipes or other components and are secured to prevent gaps such that Covered Species are unable to squeeze under the cover. If any open holes, sumps, trenches, and other excavations cannot be covered, Permittee, in consultation with the Designated Biologist(s) shall provide at least one escape ramp constructed of earthen fill or a non-slip wooden plank with a less than 1:1 (45 degree) slope for each open hole, sump, trench, or other excavation. If a situation is encountered that this measure does not anticipate and alternative methods of preventing entrapment in open holes, sumps, trenches, and other excavations are warranted, Permittee shall request and obtain CDFW's written approval prior to implementing the alternative. The Designated Biologist(s) shall inspect the condition of covers and escape ramps to ensure that covers and ramps are in effective condition, secured, and do not have gaps.	ITP Condition of Approval – Covers and Ramps	Entire Project	Permittee	
36	Project workers shall inspect under vehicles and equipment for Covered Species before the start of each workday and before vehicles and equipment are moved for any Covered Species that may be utilizing the equipment as temporary shelter. If any Project worker discovers a Covered Species, the Project worker shall notify the Designated Biologist(s). Project workers and the Designated Biologist(s) shall allow the Covered Species to move to a safe location, if possible, before Covered Activities are allowed to continue. Alternatively, the Designated Biologist(s) may move the Covered Species out of harm's way outside of the Project Area and in accordance with the CDFW-approved <u>Covered Species Mortality Reduction and Relocation Plan</u> .	ITP Condition of Approval – Vehicle and Equipment Inspection	Entire Project	Permittee	
37	Permittee shall ensure that all pipes, hoses, conduit, culverts, or similar materials stockpiled or installed in the Project Area are capped or otherwise enclosed at the ends to prevent entry by the Covered Species. Project workers shall thoroughly inspect all construction pipe, culverts, or other similar structures with a diameter of one inch or greater that are stored for one or more overnight periods for Covered Species before the object is subsequently moved, buried, or capped. If during inspection, an individual of the Covered Species is discovered inside a pipe, culvert, or similar structure, the Project worker shall immediately cease all Covered Activities in the vicinity which could injure or kill the Covered Species and notify the Designated Biologist(s). Covered Species shall be allowed to escape unimpeded to a safe location, if possible, before Covered Activities are allowed to continue. Alternatively, the Designated Biologist(s) may move Covered Species out of harm's way outside of the Project Area and in accordance with the CDFW-approved <u>Covered Species Mortality Reduction and Relocation Plan</u> .	ITP Condition of Approval – Pipes and Other Structures Entrapment Prevention	Entire Project	Permittee	
38	During all Covered Activities within the Project Area, Project workers shall inform the Designated Biologist(s) if a Covered Species is observed within or near the Project Area. All work in the vicinity of the observed Covered Species, which could injure or kill the animal, shall cease immediately until it moves from the Project Area of its own accord, or the Designated Biologist(s) relocates the Covered Species following the CDFW-approved <u>Covered Species Mortality Reduction and Relocation Plan</u> .	ITP Condition of Approval – Covered Species Observations	Entire Project	Permittee/ Designated Biologist	

	Mitigation Measure	Source	Implementation Schedule	Responsible Party	Status / Date / Initials
39	The Designated Biologist(s) shall maintain a record of all Covered Species handled and relocated. For each Covered Species handled and relocated, the Designated Biologist(s) shall report the following information: (1) date, time, and location (Global Positioning System (GPS) coordinates and maps) of capture and/or observation as well as release, if applicable; (2) the name of the party that identified the Covered Species; (3) circumstances of the incident; (4) the general condition and health, noting all visible conditions including gait and behavior, ectoparasites, injuries, etc.; (5) any diagnostic markings, sex, age (juvenile or adult); (6) actions undertaken; (7) habitat description; and (8) ambient temperature when handled, released, and or observed. Covered Species handling and relocation records shall be included in the required <u>QCRs</u> and <u>ASRs</u> . In addition, the Designated Biologist(s) shall submit this information to CDFW's CNDDDB required by Condition of Approval <u>CNDDDB Observations</u> .	ITP Condition of Approval – Record of Covered Species Handling and Relocation	Entire Project	Permittee/ Designated Biologist	
40	If a Covered Species is injured as a result of Project-related activities, the Designated Biologist(s) shall immediately take it to the CDFW-approved wildlife rehabilitation or veterinary facility per the CDFW-approved <u>Covered Species Mortality Reduction and Relocation Plan</u> . Permittee shall bear any costs associated with the care or treatment of such injured Covered Species. The Designated Biologist(s) or Designated Representative shall notify CDFW of the injury to the Covered Species immediately by e-mail followed by a written incident report required by Condition of Approval <u>Notification of Take or Injury</u> .	ITP Condition of Approval – Covered Species Injury	Entire Project	Permittee/ Designated Biologist	
41	The Designated Biologist(s) and Designated Monitor(s) shall follow the Fieldwork Code of Practice developed by the Declining Amphibian Populations Task Force at all times (see Attachment 3) to ensure that disease is not conveyed outside of the Project Area. The Designated Biologist(s) and Designated Monitor(s) may substitute a bleach solution (0.5 to 1.0 cup of bleach to 1.0 gallon of water) for the ethanol solution.	ITP Condition of Approval – Fieldwork Code of Practice	Entire Project	Permittee/ Designated Biologist	
POST-CONSTRUCTION					
42	Upon completion of Covered Activities, Permittee shall remove from the Project Area and properly dispose of all temporary fill and construction refuse, including, but not limited to, broken equipment parts, wrapping material, cords, cables, wire, rope, strapping, twine, buckets, metal or plastic containers, and boxes.	ITP Condition of Approval – Refuse Removal	Upon completion of Covered Activities	Permittee	
43	No later than 45 days after completion of all mitigation measures, Permittee shall provide CDFW with a <u>Final Mitigation Report</u> . The Designated Biologist(s) shall prepare the Final Mitigation Report which shall include, at a minimum: (1) a summary of all <u>QCRs</u> and all <u>ASRs</u> ; (2) a copy of the table in this MMRP with notes showing when each of the mitigation measures was implemented; (3) all available information about Project-related incidental take of the Covered Species; (4) information about other Project impacts on the Covered Species; (5) beginning and ending dates of Covered Activities; (6) an assessment of the effectiveness of the ITP's Conditions of Approval in minimizing and fully mitigating Project impacts of the taking on Covered Species; (7) recommendations on how mitigation measures might be changed to more effectively minimize take and mitigate the impacts of future projects on the Covered Species; (8) GIS data files depicting the total extent of permanent and temporary disturbance associated with the Project; and (9) any other pertinent information.	ITP Condition of Approval – Final Mitigation Report	No later 45 days after completion of all mitigation measures	Permittee	
44	CDFW accepts as complete the Permittee's Final Mitigation Report required by the ITP.		Upon completion of Covered Activities	CDFW	

Biologist/Botanist Resume Submittal Cover Sheet**Project Name:** _____**ITP Number:** _____****Please submit each resume as a separate file. Use of this cover sheet will expedite CDFW review.******Please provide the names of up to ten individuals in the order you would like CDFW to review for approval.****Number of resumes included in Transmittal:** _____

	Name	Requested Role¹	Covered Species	COA #(s) to implement (Monitor only)²
1		<input type="checkbox"/> Designated Biologist <input type="checkbox"/> Designated Monitor <input type="checkbox"/> Both		
2		<input type="checkbox"/> Designated Biologist <input type="checkbox"/> Designated Monitor <input type="checkbox"/> Both		
3		<input type="checkbox"/> Designated Biologist <input type="checkbox"/> Designated Monitor <input type="checkbox"/> Both		
4		<input type="checkbox"/> Designated Biologist <input type="checkbox"/> Designated Monitor <input type="checkbox"/> Both		
5		<input type="checkbox"/> Designated Biologist <input type="checkbox"/> Designated Monitor <input type="checkbox"/> Both		
6		<input type="checkbox"/> Designated Biologist <input type="checkbox"/> Designated Monitor <input type="checkbox"/> Both		
7		<input type="checkbox"/> Designated Biologist <input type="checkbox"/> Designated Monitor <input type="checkbox"/> Both		
8		<input type="checkbox"/> Designated Biologist <input type="checkbox"/> Designated Monitor <input type="checkbox"/> Both		
9		<input type="checkbox"/> Designated Biologist <input type="checkbox"/> Designated Monitor <input type="checkbox"/> Both		
10		<input type="checkbox"/> Designated Biologist <input type="checkbox"/> Designated Monitor <input type="checkbox"/> Both		

Reviewed and submitted by: _____ **Date:** _____

Permittee or Designated Representative

¹ Requested roles correspond to the biological staffing requirements indicated in the Incidental Take Permit (ITP). Roles may include a "Designated Biologist" with the necessary experience to survey for special-status species or a "Designated Monitor" with the necessary experience to monitor construction activities for special-status species. More than one role may be requested for an individual.

² Please contact the Regional Representative specified in the ITP with any questions about the Condition of Approval numbers for Designated Monitors.

***** Please Note: While use of this form is not mandatory, CDFW strongly recommends completing this form as it will ensure the receipt of adequate information and expedite CDFW review of biologist's qualifications. By submitting your resume for review and approval, you are acknowledging that you have received a copy of the ITP, have read it, and understand the role of a Designated Biologist (DB) and Designated Monitor (DM) and the responsibilities of a DB or DM required by the ITP. *****

Name of Biologist & Contact Information

Education: (include year graduated)

Training/Workshops: (be prepared to provide copies of certificates upon request; these should be related to the Covered Species (or similar species) in the Incidental Take Permit)

Certifications: (please provide any copies of a CDFW Scientific Collecting Permit, MOU, or USFWS 10(a)(1)(A)) permit; these should be related to the Covered Species (or similar species) in the Incidental Take Permit)

Species Name #1: (Example: California Tiger Salamander)

Project Name #1 (list the information below for all projects (separately) where biologist worked with this species; projects may be listed more than once under each separate species and please only include projects on the resume that demonstrate experience with the Covered Species (or similar species) in the ITP)

Location:

Project date completed: To and from date (month and year)

Incidental Take Permit (ITP) # (and Other Agency Permits):

Lead biologist Information: Name and contact information (phone number and email address)

Reference: Name and contact information, if different from above (phone number and email address)

Work description:

Estimated Survey Hours:

Estimated Monitoring Hours:

Individuals Observed: # of adults and # of juveniles

Individuals Handled: # of adults and # of juveniles

Burrows excavated:

Project Name #2

Location:

Project date completed: To and from date

Incidental Take Permit # (and Other Agency Permits):

Lead biologist Information: Name and contact information (phone number and email address)

Reference: Name and contact information, if different from above (phone number and email address)

Work description:

Estimated Survey Hours:

Estimated Monitoring Hours:

Individuals Observed: # of adults and # of juveniles

Individuals Handled: # of adults and # of juveniles

Burrows excavated:

Project Name #3 ...

Species Name #2: (Example: Similar or related species to CTS)

Project Name #1 (list the information below for all projects (separately) where the biologist worked with this species)

Location:

Project date completed: To and from date

Incidental Take Permit # (and Other Agency Permits):

Lead biologist Information: Name and contact information (phone number and email address)

Reference: Name and contact information, if different from above (phone number and email address)

Work description:

Estimated Survey Hours:

Estimated Monitoring Hours:

Individuals Observed: # of adults and # of juveniles

Individuals Handled: # of adults and # of juveniles

Burrows excavated:

Project Name #2

Location:

Project date completed: To and from date

Incidental Take Permit # (and Other Agency Permits):

Lead biologist Information: Name and contact information (phone number and email address)

Reference: Name and contact information, if different from above (phone number and email address)

Work description:

Estimated Survey Hours:

Estimated Monitoring Hours:

Individuals Observed: # of adults and # of juveniles

Individuals Handled: # of adults and # of juveniles

Burrows excavated:

Project Name #3 ...

Include any other relevant experience with the Covered Species (or related species) or implementation of Conditions of Approval in the ITP (for example: species relocation, etc.)

The Declining Amphibian Task Force Fieldwork Code of Practice

A code of practice, prepared by the Declining Amphibian Task Force (DAPTF) to provide guidelines for use by anyone conducting field work at amphibian breeding sites or in other aquatic habitats. Observations of diseased and parasite-infected amphibians are now being frequently reported from sites all over the world. This has given rise to concerns that releasing amphibians following a period of captivity, during which time they can pick up unapparent infections of novel disease agents, may cause an increased risk of mortality in wild populations. Amphibian pathogens and parasites can also be carried in a variety of ways between habitats on the hands, footwear, or equipment of fieldworkers, which can spread them to novel localities containing species which have had little or no prior contact with such pathogens or parasites. Such occurrences may be implicated in some instances where amphibian populations have declined. Therefore, it is vitally important for those involved in amphibian research (and other wetland/pond studies including those on fish, invertebrates and plants) to take steps to minimize the spread of disease and parasites between study sites.

1. Remove mud, snails, algae, and other debris from nets, traps, boots, vehicle tires and all other surfaces. Rinse cleaned items with sterilized (e.g. boiled or treated) water before leaving each study site.
2. Boots, nets, traps, etc., should then be scrubbed with 70% ethanol solution (or sodium hypochlorite 3 to 6%) and rinsed clean with sterilized water between study sites. Avoid cleaning equipment in the immediate vicinity of a pond or wetland.
3. In remote locations, clean all equipment as described above upon return to the lab or "base camp". Elsewhere, when washing machine facilities are available, remove nets from poles and wash with bleach on a "delicates" cycle, contained in a protective mesh laundry bag.
4. When working at sites with known or suspected disease problems, or when sampling populations of rare or isolates species, wear disposable gloves and change them between handling each animal. Dedicate sets of nets, boots, traps, and other equipment to each site being visited. Clean and store them separately and the end of each field day.
5. When amphibians are collected, ensure the separation of animals from different sites and take great care to avoid indirect contact between them (e.g. via handling, reuse of containers) or with other captive animals. Isolation from un-sterilized plants or soils which have been taken from other sites is also essential. Always use disinfected/disposable husbandry equipment.
6. Examine collected amphibians for the presence of diseases and parasites soon after capture. Prior to their release or the release of any progeny, amphibians should be quarantined for a period and thoroughly screened for the presence of any potential disease agents.
7. Used cleaning materials (liquids, etc.) should be disposed of safely and if necessary taken back to the lab for proper disposal. Used disposable gloves should be retained for safe disposal in sealed bags.